

# Catalogue

## HAUTAU ATRIUM Alu-HKS® 200

for aluminium systems



**HAUTAU**



# **HAUTAU Catalogue**

## **Tilt and Slide Fittings ATRIUM Alu-HKS® 200**

# **2017**

**Version 08/2017**

You will find the latest catalogue version online  
on [www.HAUTAU.de](http://www.HAUTAU.de)

**HAUTAU GmbH**

P.O.Box 1151  
D 31689 Helpsen  
Phone 05724/393-0  
Telefax 05724/393-125  
Info@HAUTAU.de  
[www.HAUTAU.de](http://www.HAUTAU.de)

Registered office in Helpsen, Managing Directors Petra Hautau and Klaus-Dieter Vehling  
Trade register Stadthagen · HRB No. 2565

Bank information

Volksbank in Schaumburg eG (Routing No. 25591413) Account 645273600  
IBAN: DE19255914130645273600 · SWIFT: GENODEF1BCK

Postbank Hannover (Routing No. 25010030) Account 3887-305  
IBAN: DE63250100300003887305 · SWIFT: PBNKDEFF250

Sales Tax ID: DE 811 213 544

Printed in Germany · Reprint, even in excerpts, not without the publisher's approval.

In consideration of progress, we reserve the right to apply construction modifications and to consequently change any figures, dimensions, weight specifications etc. The figures do not show items in their actual size and are also not of the same proportion.



# Contents

<b>Tilt and slide fittings ATRIUM Alu-HKS® for aluminium systems</b>	Page
Product description .....	6
Range of application and technical specifications ATRIUM Alu-HKS® 200 Z .....	8
Range of application and technical specifications ATRIUM Alu-HKS® 160 S .....	10
Sash arrangement .....	12
Text for invitations of tenders .....	13
Order information and packing units, colour information and abbreviations .....	14
System requirements (chamber dimensions/grooves/locking rods) .....	15
Overview - contents of the packing units .....	16
 <b>Fitting parts:</b>	
ATRIUM Alu-HKS® 200 Z TWIN for sash weights of up to 200 kg .....	18
ATRIUM Alu-HKS® 200 Z for sash weights of up to 160 kg .....	20
ATRIUM Alu-HKS® 200 Z for sash weights of up to 100 kg .....	22
ATRIUM Alu-HKS® 160 S /10 for sash weights of up to 160 kg .....	24
ATRIUM Alu-HKS® 160 S /6 for sash weights of up to 160 kg .....	26
ATRIUM Alu-HKS® 160 S /10 for sash weights of up to 100 kg .....	28
ATRIUM Alu-HKS® 160 S /6 for sash weights of up to 100 kg .....	30
ATRIUM Alu-HKS® 160 o.V. for sash weights of up to 160 kg .....	32
ATRIUM Alu-HKS® 160 o.V. for sash weights of up to 100 kg .....	34
ATRIUM Alu-HKS® 160 S RC2 for sash weights of up to 160 kg .....	36
 <b>Accessories:</b>	
Gear types .....	38
Handles .....	40
Stock lengths / Accessories .....	42
Strikers .....	44
Mounting tools .....	46
Documentation .....	47





# ATRIUM Alu-HKS® 200 for aluminium tilt and slide elements with sash weights of up to 200 kg



Slide position

### Opening width 117 mm

Its opening width of 117 mm makes the new ATRIUM Alu-HKS® 200 an excellent choice for deep sash profiles and meets all requirements expected from highly efficient heat insulating window systems.

### Bogie design requiring only 35 mm of space, maximum roller diameter, concealed control system, and self-locking height adjustment

The new bogies of the ATRIUM Alu-HKS® 200 have a roller diameter of 28 mm and a closed housing but require only 35 mm of space.

A concealed control system and the non-soiling guide block guarantee a long lifespan as well as easy and convenient operation. Only one tool is required to adjust the sash thanks to the self-locking height adjustment including safety clip.

### Bogie ATRIUM Alu-HKS® 200 Z TWIN

The new bogie ATRIUM Alu-HKS® 200 Z TWIN including one-part housing prevents sash skews and supports sash weights of up to 200 kg. The pre-assembled bogies reduce the assembly time considerably.

### Anti-mishandling device HAUTAU onTop

The new anti-mishandling device HAUTAU onTop works in an efficient and convenient way. It also prevents the sash from being lifted out. Thanks to its position facing away from the handle on the sash side, the anti-mishandling device can also be used in combination with French doors (scheme C).

### Sash heights and sash widths of up to 2700 mm and 2000 mm, respectively

Thanks to the rugged design of its stays and bogies, the ATRIUM Alu-HKS® 200 can be used for sash heights of up to 2700 mm. This fitting system, therefore, meets the architectonic challenge of providing window doors that are as tall as the room.

### Running rail

Sash weights of up to 160 kg no longer require that the running rail be supported, provided the specified screw tightening torques are observed.

### PVC spring-loaded catches

The spring-loaded catches made of PVC let the fitting engage smoothly and quietly into its tilt position and, thereby, guarantee its reliable and convenient operation.

### Range of application

For aluminium systems with sash groove 15/20.

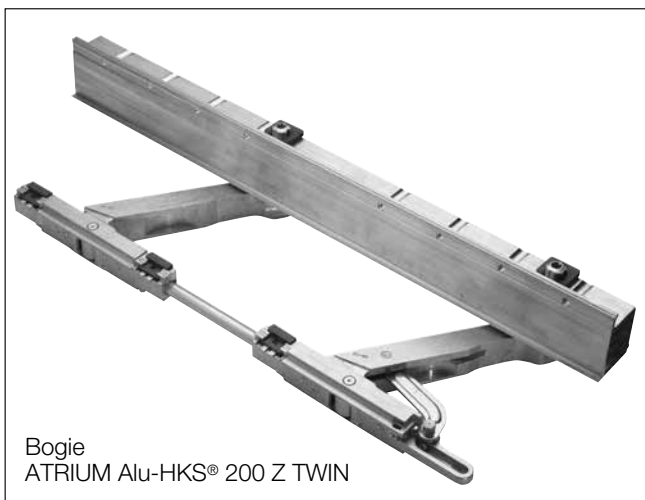

Bogie  
ATRIUM Alu-HKS® 200 Z TWIN



Bogie cover and cover caps  
are colour-matched



- Automatic sash engagement in the slide position for easy operation
- Secure frame-sash connection with visual control option on the glider
- Tilt lock strikers perfectly match the visual appeal of high-quality aluminium profiles
- Height adjustment requires only one tool
- Non-soiling guide block with concealed entry for faultless permanent operation

**Combined with HAUTAU design handle including gear with fork drive (AG)**

- Increased functional reliability thanks to reduced play in the connection between the handle of the gear with fork drive and the central locking gear
- The selection of different locking parts makes it possible to use a variety of different locking rods
- Thanks to the adjustment options of the central locking gear, compensating for cutting tolerances requires no effort at all and can be done by simply shifting the position of the new adjusters with dimensional grid
- Adjustable support arms make it possible to perfectly adjust the sash entry and sash exit to the different installation depths
- The newly designed packaging allows for a multitude of different variation options and keeps storage costs at a minimum
- Torx screws ensure that the fitting parts can be connected in a fast and secure manner
- Top and bottom fitting parts reliably stop the sash in any opening position
- Cleaning brushes on the bogies ensure a long lifespan and smooth operation
- Short distance between supporting bolt and sash for perfect weight support and minimum stress on the sash profile
- Narrow, shapely bogie cover
- The stay packet with its installation height of only 9 mm provides for the greatest possible height adjustment of the sash
- Handle in closed down position for intuitive use

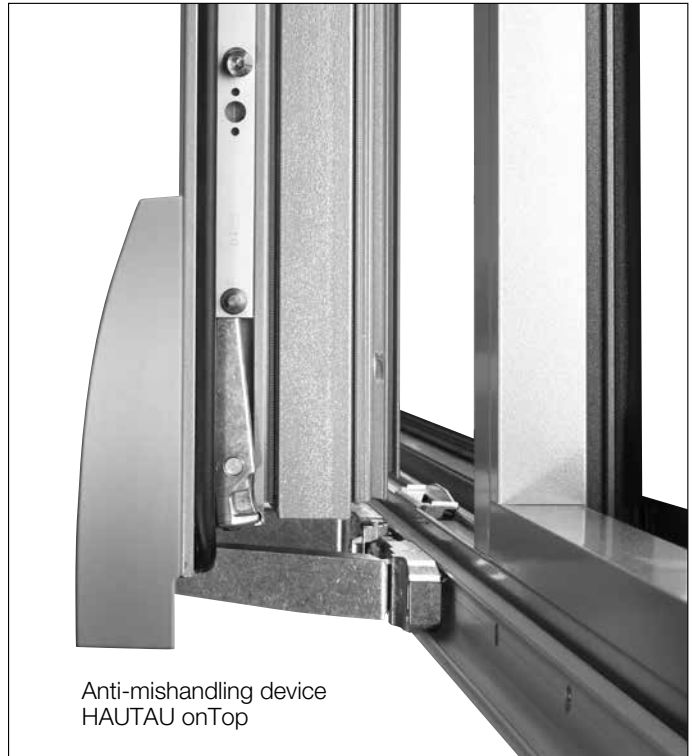

Anti-mishandling device  
HAUTAU onTop



Reduced play in the connection  
between the handle of the gear with  
fork drive and the central locking gear



Adjustable support arm allows  
for the perfect adjustment of the  
entry and exit behaviour of the  
sash



## Range of application

# ATRIUM Alu-HKS® 200 Z TWIN / 200 Z

ATRIUM Alu-HKS® 200 Z TWIN / 200 Z with groove 15/20 with support arms for sash weights of up to 200 kg

ATRIUM Alu-HKS® 200 Z with groove 15/20 without support arms for sash weights of up to 100 kg

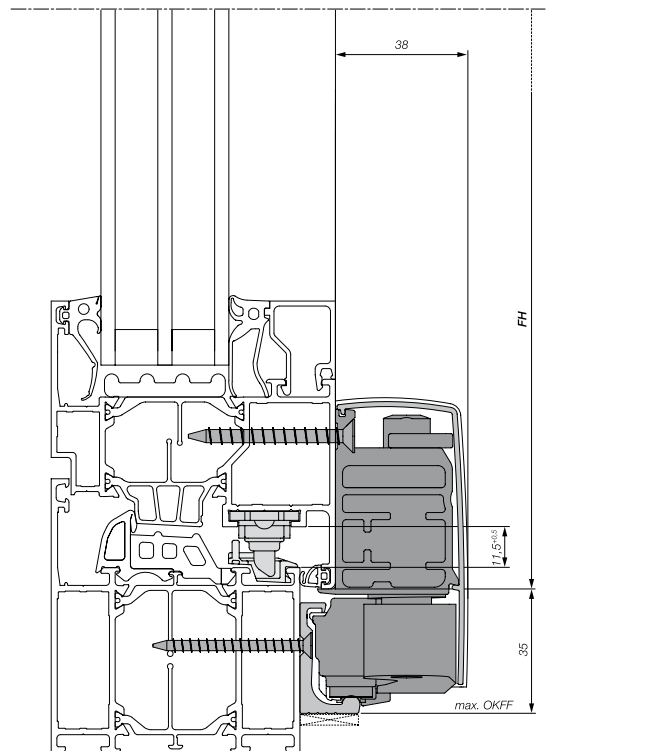
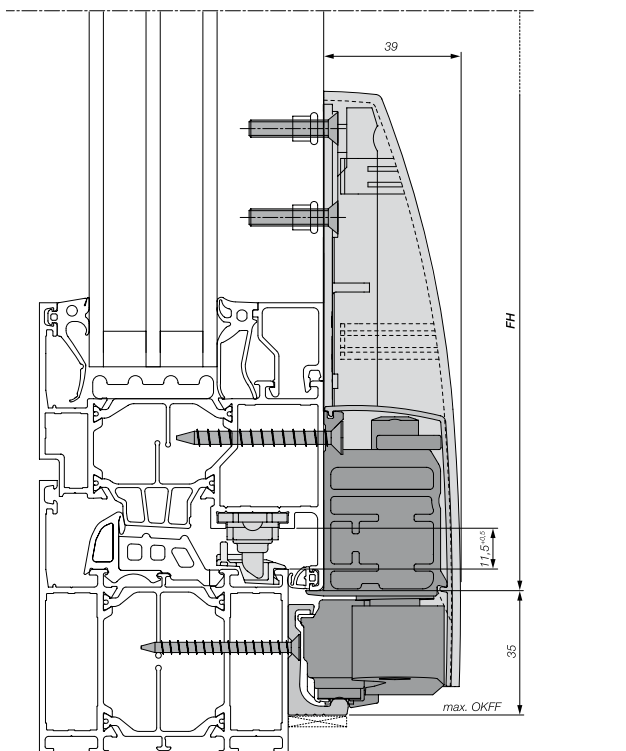
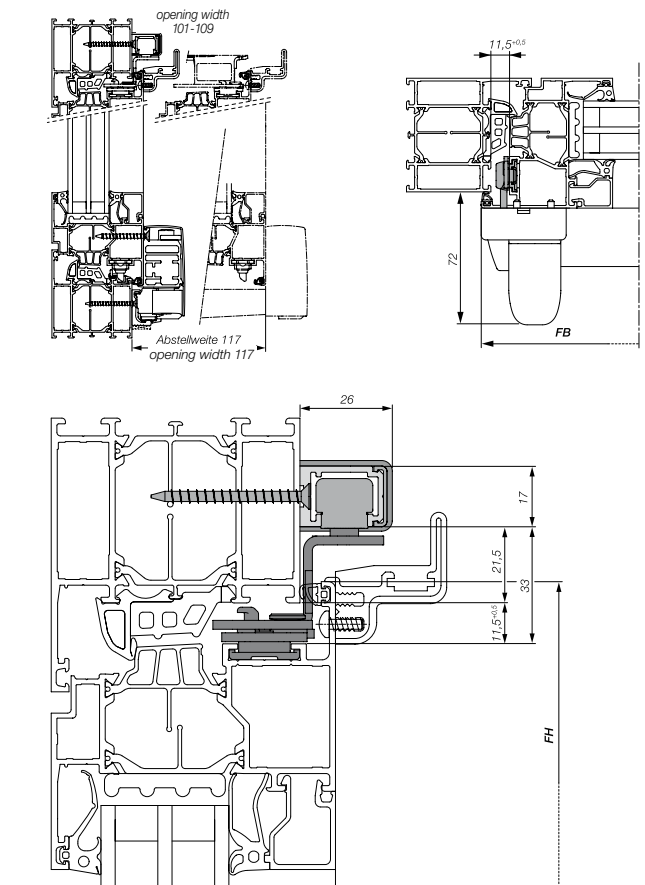
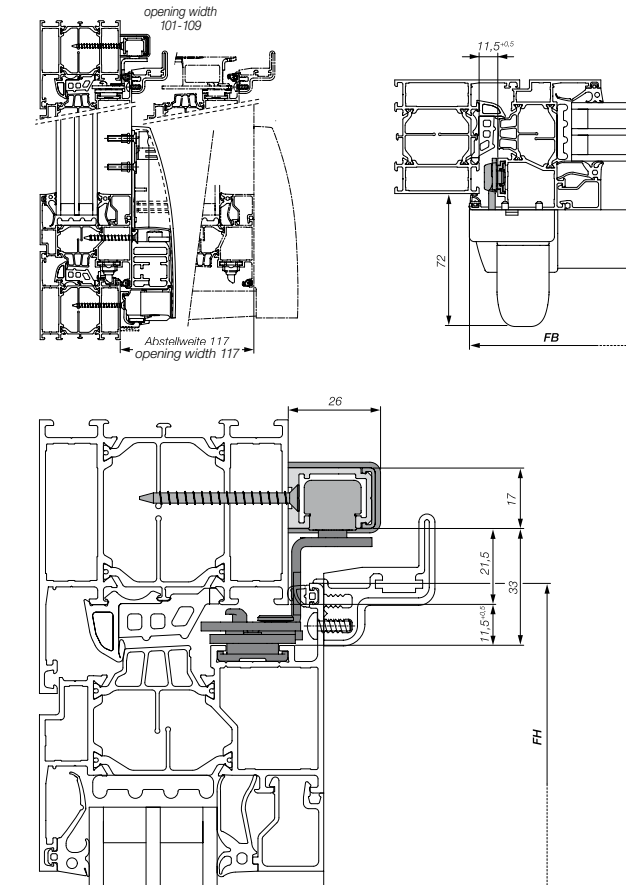





## Technical specifications

### ATRIUM Alu-HKS® 200 Z TWIN

**Sash width (FB)** 1080 - 2000 mm  
**Sash height (FH)** 930 - 2700 mm  
**Sash weight** max. 200 kg<sup>1)</sup>

<sup>1)</sup> Sash weights of 160 to 200 kg require TWIN bogies and spring stay.

### ATRIUM Alu-HKS® 200 Z

**Sash width (FB)** 670 (830)\* - 2000 mm  
**Sash height (FH)** 930 - 2700 mm  
**Sash weight** max. 160 kg<sup>1)</sup>

\* with spring stay

<sup>1)</sup> Sash weights of 100 to 160 kg and a sash depth > 75 mm require a spring stay.

### ATRIUM Alu-HKS® 200 Z, sash weight max. 100 kg

**Sash width (FB)** 670 - 1280 mm  
**Sash height (FH)** 930 - 2380 mm  
**Sash weight** max. 100 kg

### Sash depths

Max. sash depth (FT) 87 mm

Sash depths > 87 mm are possible after technical approval of curve and sash centre of gravity.

### Space requirements

Frame dimensional tolerance

Running rail, bottom:	35 mm
Guiding rail, top:	32 mm
Running rail depth:	17 mm

Rebate step height: at least 7 mm

### Important notes

FH : FB = max. 2 : 1

The limits specified for the ranges of application must be adhered to and not be exceeded. Please also follow the permissible application sizes, manufacturing instructions and processing guidelines as provided by the profile manufacturers.

Take appropriate precautions to prevent the element from being overstrained by forced closing in special environments such as schools, kindergartens, etc. Please note that the elements are also susceptible to damage when used in moving objects such as trains or ships.

When in doubt, please contact our sales consultants.

### ATRIUM Alu-HKS® 200 Z TWIN, max. 200 kg

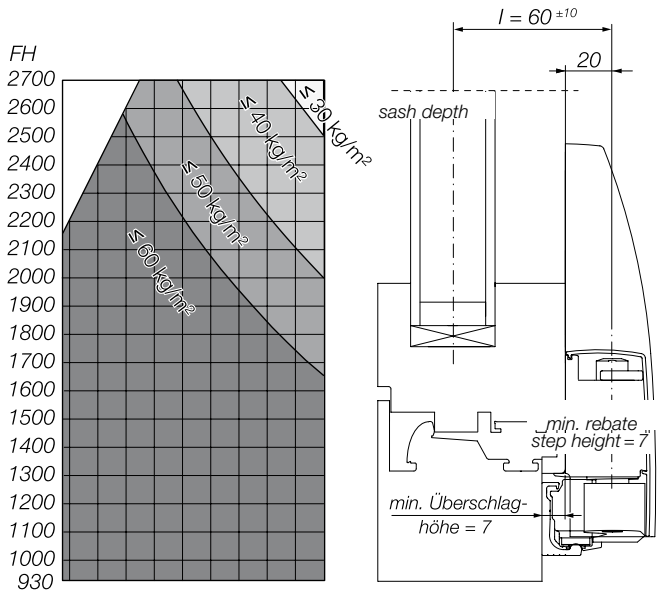

### ATRIUM Alu-HKS® 200 Z, max. 160 kg

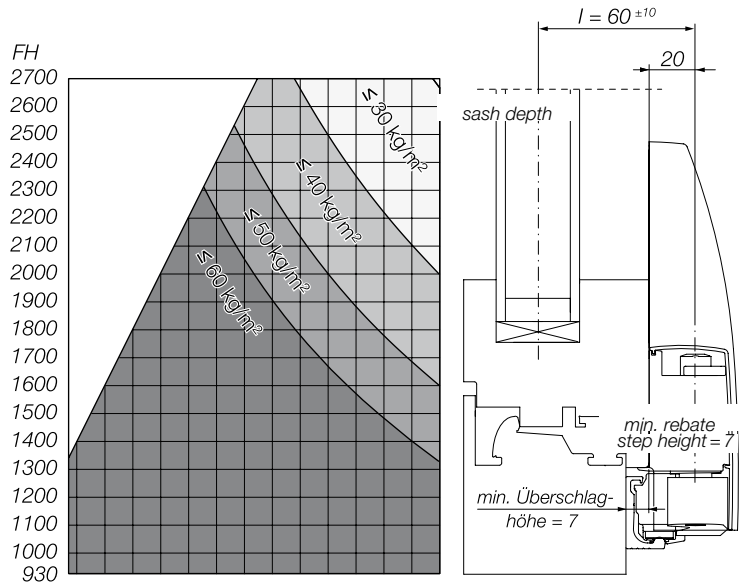

### ATRIUM Alu-HKS® 200 Z, max. 100 kg

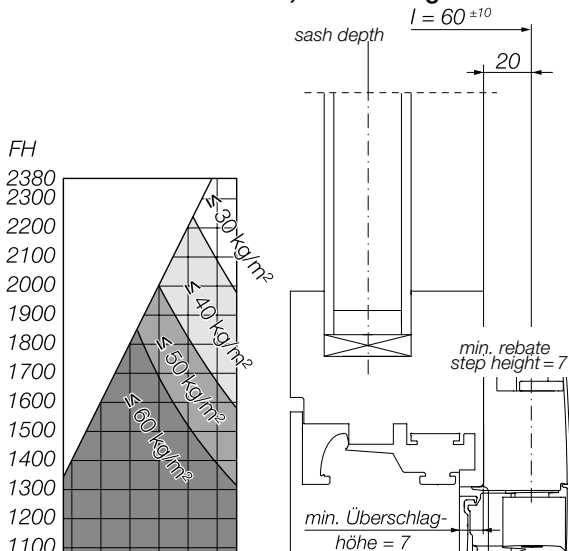



# Range of application

## ATRIUM Alu-HKS® 160 S

ATRIUM Alu-HKS® 160 S with groove 15/20  
with support arms for sash weights of up to 160 kg

ATRIUM Alu-HKS® 160 S with groove 15/20  
without support arms for sash weights of up to 100 kg

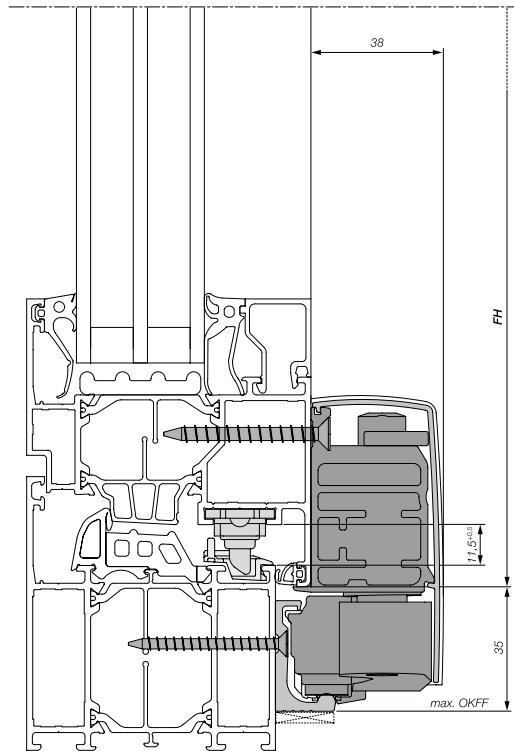
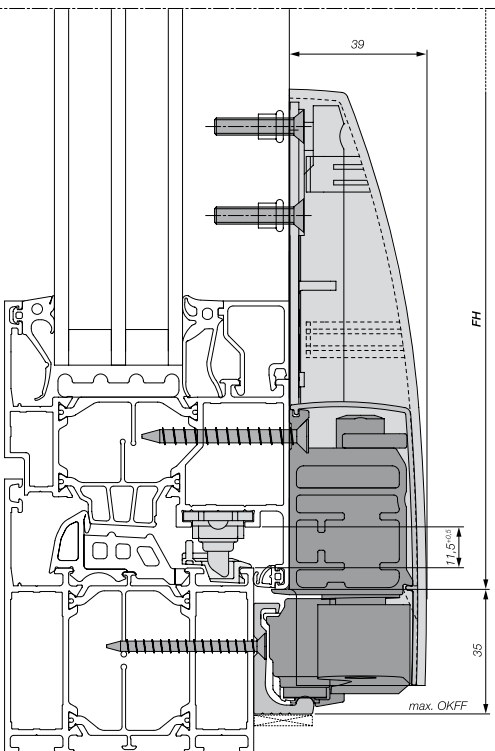
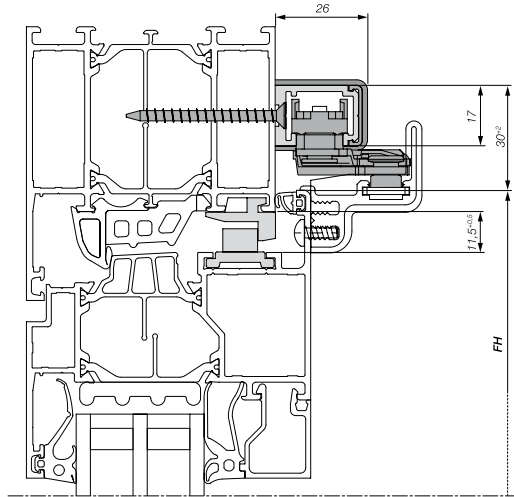
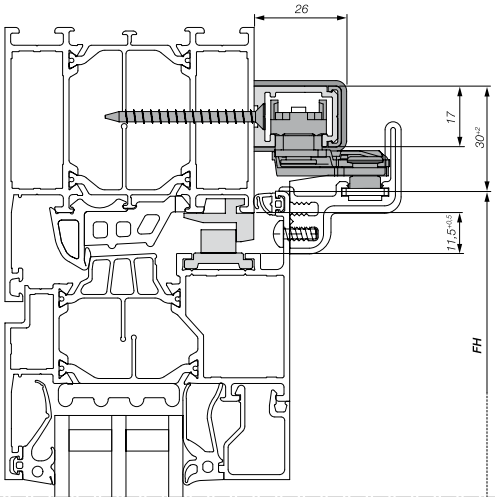
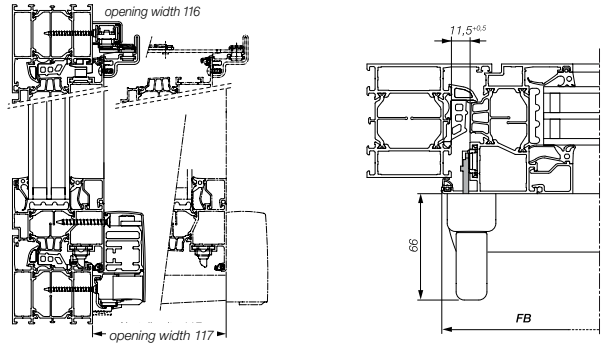
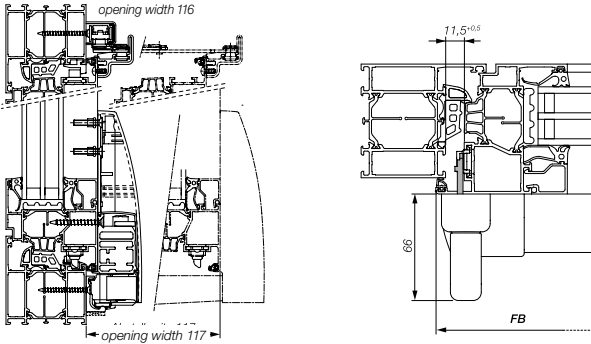



## Technical specifications

### ATRIUM Alu-HKS® 160 S

Sash width (FB) 670 - 1680 mm  
 Sash height (FH) 930 - 2380 mm  
 Sash weight max. 160 kg

### ATRIUM Alu-HKS® 100 S

Sash width (FB) 670 - 1280 mm  
 Sash height (FH) 930 - 2380 mm  
 Sash weight max. 100 kg

### Sash depths

Max. sash depth (FT) 87 mm  
 Sash depths > 87 mm are possible after technical approval of curve and sash centre of gravity.

### Space requirements

Frame dimensional tolerance  
 Running rail, bottom: 35 mm  
 Guiding rail, top: 32 mm  
 Running rail depth: 17 mm  
 Rebate step height: at least 7 mm

### Important notes

FH : FB = max. 2 : 1  
 The limits specified for the ranges of application must be adhered to and not be exceeded.  
 Please also follow the permissible application sizes, manufacturing instructions and processing guidelines as provided by the profile manufacturers.

Take appropriate precautions to prevent the element from being overstrained by forced closing in special environments such as schools, kindergartens, etc. Please note that the elements are also susceptible to damage when used in moving objects such as trains or ships.

When in doubt, please contact our sales consultants.

### ATRIUM Alu-HKS® 160 S

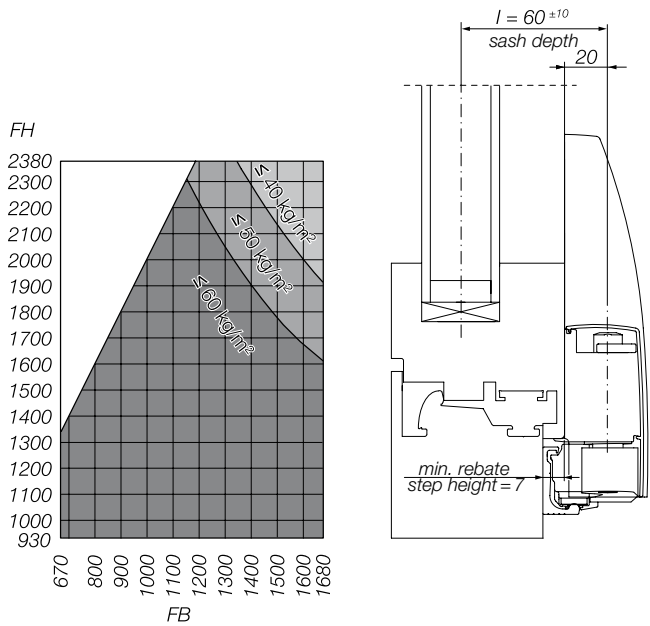

### ATRIUM Alu-HKS® 100 S

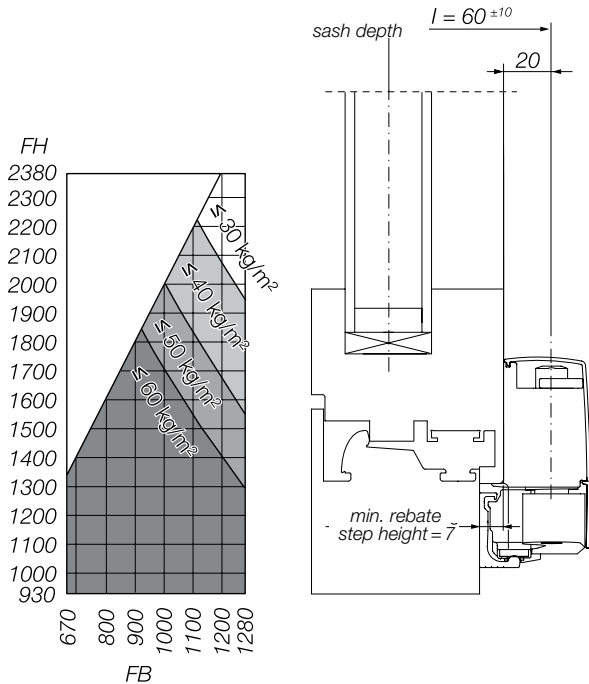



# Sash arrangements

**Frames with solid glazing or side hung sashes** Schemes A, G, K, and C

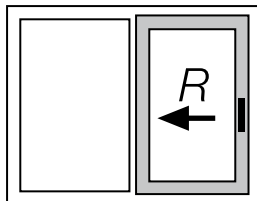

Scheme A  
Two-part element:  
1 Sliding sash (L or R)

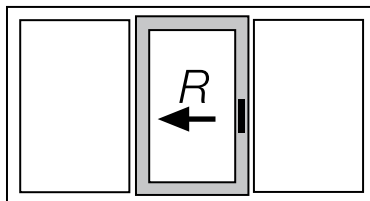

Scheme G  
Three-part element:  
1 Sliding sash (L or R)

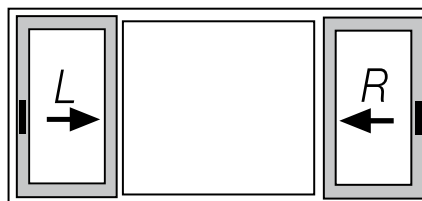

Scheme K  
Three-part element:  
2 Sliding sashes (L and R)

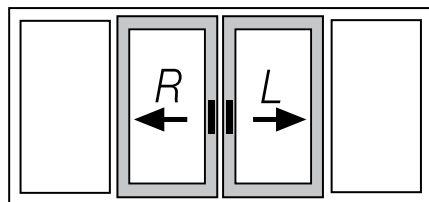

Scheme C  
Four-part element:  
2 sliding sashes (L and R)  
with mounting posts between Alu-HKS elements

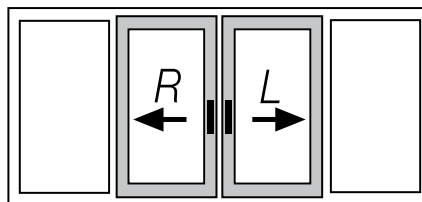

Scheme C\*  
Four-part element:  
2 sliding sashes (L or R),  
without mounting posts between the sliding sashes

**Frames without fixed mounting post between side hung and sliding sash** Scheme A

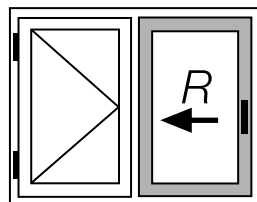

Scheme A  
Two-part element:  
1 sliding sash (L or R),  
1 side hung sash  
When ordering two-part elements  
without fixed mounting post: order  
central locking gear separately.

Caution!  
Movable guide block required.

HAUTAU design left = DIN EN 12519 opening to the right  
HAUTAU design right = DIN EN 12519 opening to the left

## Text for invitations of tenders

### ATRIUM Alu-HKS® 200 Z

Parallel tilt and slide fitting HAUTAU ATRIUM Alu-HKS® 200 Z

- Automatically operated central locking gear for automatic enabling and disabling of the tilt function
- Concealed central locking gear with adjustable locking cam closing pressure
- Integrated anti-mishandling device
- Parallel stop and slide position 117 mm
- Sash width of up to 2000 mm
- Sash height of up to 2700 mm
- Sash weight of up to 200 kg

Product: HAUTAU ATRIUM Alu-HKS® 200 Z

### ATRIUM Alu-HKS® 160 S

Parallel tilt and slide fitting HAUTAU ATRIUM Alu-HKS® 160 S

- Spring catch in tilt position, anti-slam stay system
- Concealed central locking gear with adjustable locking cam closing pressure
- Parallel stop and slide position 117 mm
- Sash width of up to 1680 mm
- Sash width of up to 2380 mm
- Sash weight of up to 160 kg

Product: HAUTAU ATRIUM Alu-HKS® 160





## Order details and packing units

Packing unit	Alu-HKS® 200 Z with automatic operation	Alu-HKS® 160 S / 10 with spring-loaded catches	Alu-HKS® 160 S / 6 with spring-loaded catches	Alu-HKS® 160 S / o.V. with spring-loaded catches
<b>Carton of bogies</b>	200 Z / 200 Z TWIN	200 Z		
<b>Basic carton</b>	Alu-HKS® 200 Z	Accessories locking system 10	Accessories locking system 6	
<b>Spring stay</b>	depending on sash depth and weight			
<b>Carton Caps for bogies</b>	according to sash weight			
<b>Handle</b>	203 / 201	161 / UG		
<b>Strikers</b>	according to table			
<b>Set of rails</b>	FB 930 mm FB 1080 mm FB 1280 mm FB 1480 mm FB 1680 mm FB 2000 mm* *(TWIN only)	FB 930 mm FB 1080 mm FB 1280 mm FB 1480 mm* FB 1680 mm* *(160 kg only)		
<b>Snap lock rods</b>				
<b>Stay system</b>	according to sash width			

## Colour information

	Design natural blank	Design silver	Design white	Design black	Design brown
Guiding rail	EV 1* natural anodised	EV 1* natural anodised	EV 1* natural anodised	EV 1* natural anodised	EV 1* natural anodised
Running rail	EV 1* natural anodised	EV 1* natural anodised	EV 1* natural anodised	black, anodised C35	brown, anodised C34
Holding rail and cover profile	natural blank	silver, coated	white, coated RAL 9016	black, coated RAL 9005	brown, coated 8077
Cover caps	colour-matched				

\* EV 1 corresponds to C0

### Coating process for design „natural blank“:

The running and guide tracks may not be powder coated. Anodized surfaces are allowed only. Holding track and cover profile are both powder or liquid coatable.

For the cover caps apply the following procedures (process instructions):

- Plasma pretreated process in a vacuum chamber
- Cleaning process with ionized air
- 2K acrylic paint
- Oven drying at 70 degrees

# System requirements

## Chamber dimensions and grooves

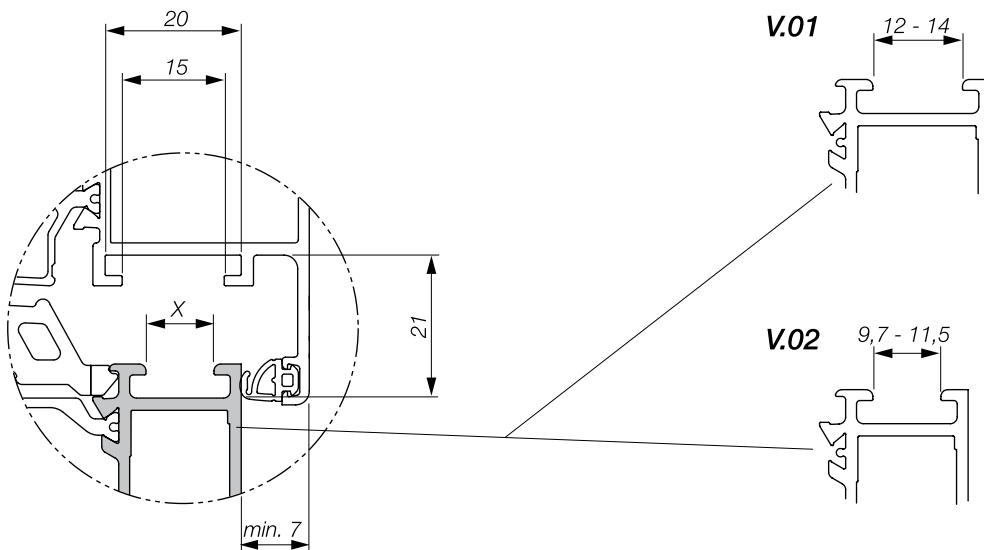

## Locking rods

Design  
Rivet stud D6

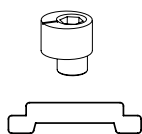

Design  
Insertion stud D10

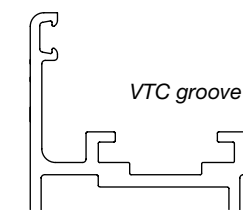
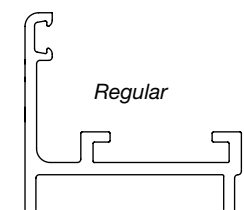
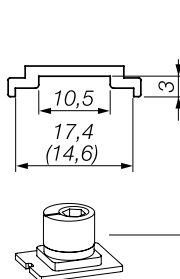

Depending on the locking (drive) rod used, design D6 or design D10 will be required.



# Overview - contents of the packing units

## ATRIUM Alu-HKS® 200 Z TWIN / 200 Z

	<p>Maintenance and operating manual 19          Radiationschutzfilter          Operating label 2x 24          Auslösestift für Gleit-          entrastung 1x          M5 x 25 PKS</p>
	<p>FG &gt; 160 kg or          FG &gt; 100 kg and          FT &gt; 75 mm</p> <p>&gt; 160 kg          1x 1a          1x 2a          2x 4 (&gt; 160 kg 1x)          12x 4,8 x 50          24x 4,8 x 50          59b</p>
	<p>Flügelgewicht 100 kg</p> <p>4x 76          2x Sash weight ≥ 100 kg          4x M5 x 25 59d          1x 44          1x 45</p> <p>Flügelgewicht &lt; 100 kg</p> <p>Sash weight &lt; 100 kg          44          45</p>
	<p>AG 6          AG-S 7          2x 4,8 x 50 59b          2x M5 x 25 59          1x 8          2x M5 x 8</p>
	<p>2x 15          8x 13          1x 66          1x 16          D10 3x 56          D6 3x 56a</p>
	<p>1x 35          1x 36          1x 38          1x 37          1x 39          1x 40          40x 3,9 x 45 59c          10x 3,9 x 9,5 59e          FB &gt; 1480 1x 51</p>





# Overview - contents of the packing units

## ATRIUM Alu-HKS® 160 S

	<p>1x ① </p> <p>1x ② </p> <p>2x ④ </p> <p>12x 4,8 x 50 ⑤ </p>
	<p>D10</p> <p>3x ⑱ </p> <p>1x ⑧ </p> <p>1x ⑤⑥ </p> <p>D6</p> <p>3x ⑱ </p> <p>1x ⑧ </p> <p>1x ⑥③ </p> <p>EG-Pz ⑥⑤ </p> <p>EG ③① </p>
	<p>UG</p> <p>⑥a </p> <p>2x M5 x 8 </p> <p>EG ⑨ </p> <p>EG-S ⑩ </p> <p>EG-PzA ⑫a </p> <p>EG-PzI ⑪a </p> <p>EG ②⑧ </p> <p>EG ⑥⑤ </p> <p>EG ⑥⑤ </p>
	<p>1x ⑥① </p> <p>1x ⑥② </p> <p>2x ⑥⑤ </p> <p>1x ⑥⑥ </p> <p>Wartungs- und Maintenance and operating manual </p> <p>Bedienungs-anleitung Operating label </p>
	<p>Flügelgewicht ≥ 100 kg Sash weight ≥ 100 kg</p> <p>1x ④④ </p> <p>④⑤ </p> <p>2x ③ </p> <p>4x M5 x 25 ⑤⑨d </p> <p>Flügelgewicht &lt; 100 kg Sash weight &lt; 100 kg</p> <p>④④ </p> <p>④⑤ </p>
	<p>②⑥ </p>
	<p>2x ⑮ </p> <p>D10</p> <p>3x ⑤⑥ </p> <p>8x ⑬ </p> <p>D6</p> <p>3x ⑤⑥a </p> <p>8x ⑬ </p>
	<p>1x ③⑤ </p> <p>1x ③⑥ </p> <p>1x ③⑧ </p> <p>1x ③⑦ </p> <p>1x ③⑨ </p> <p>1x ④① </p> <p>④② </p> <p>④③ </p> <p>④④ </p> <p>④⑤ </p> <p>④⑥ </p> <p>④⑦ </p> <p>④⑧ </p> <p>2x ④① </p> <p>1x ⑤① </p> <p>1x ⑤② </p> <p>1x ⑤③ </p> <p>1x ⑤④ </p> <p>1x ⑤⑤ </p> <p>1x ⑤⑥ </p> <p>1x ⑤⑦ </p> <p>1x ⑤⑧ </p> <p>40x 3,9 x 45 ⑤⑨c </p> <p>10x 3,9 x 9,5 ⑤⑨e </p> <p>FB &gt; 1480</p> <p>1x ⑤① </p>



# ATRIUM Alu-HKS® 200 Z TWIN

with automatic operation for sash weights of up to 200 kg

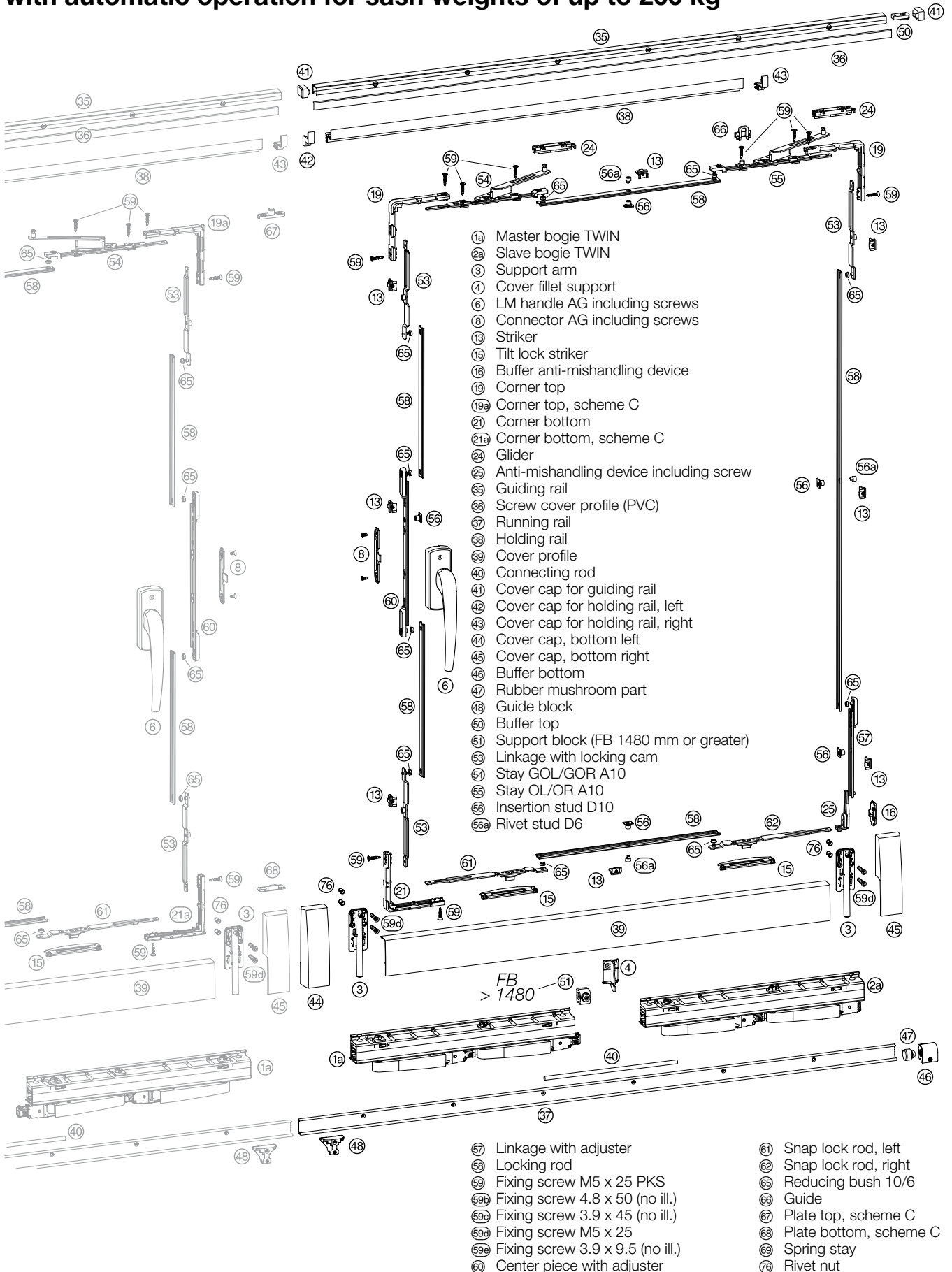



# ATRIUM Alu-HKS® 200 Z TWIN

with automatic operation for sash weights of up to 200 kg

Unit per scheme

A	G	K	C	Item name	Item code
1	1	2	1L 1R	<b>Carton of bogies Alu-HKS® 200 TWIN</b> 19 2a 4 59b	left 230503 right 230500
1	1	2	2	<b>Caps bogies, large + support arms Alu-HKS®</b> 3 44 45 59a 76 <b>silver</b> <b>white</b> <b>black</b> <b>brown</b> <b>blank</b> 230521 230527 230524 240418 230518	
1	1	2	1	<b>Basic carton Alu-HKS® Z</b> 19 21 24 25 53 54 55 56 57 59 60 61 62 65	left 233425 right 233428
			1	<b>Basic carton scheme C Alu-HKS® Z</b> 19a 21a 24 25 53 54 55 56 57 59 60 61 62 65	right 233431
1	1	2	1L 1R	<b>LM HAUTAU design handle with AG</b> 6 8 <b>203 AG</b> <b>EV 1</b> <b>white</b> <b>black</b> <b>brown</b> left 230428 230434 230440 240173 right 230425 230431 230437 240170	
1	1	2	2	<b>Bag of accessory strikers (profile-related)</b> 13 15 16 56 56a 66 see striker table, page 45	
1	1	2	2	<b>Rail set Alu-HKS®</b> 55 56 57 58 59 40 41 42 43 46 47 48 50 59c 59e also for FB 1480 or greater: 51	<b>FB/RAB</b> <b>silver</b> <b>white</b> <b>black</b> <b>brown</b> <b>blank</b> 930/1930 230536 230539 230530 238819 230533 1080/2230 230548 230551 230542 238822 230545 1280/2630 230560 230563 230554 238825 230557 1480/3030 230572 230575 230566 238828 230569 1680/3430 230584 230587 230578 238831 230581 2000/4130 230596 230599 230590 238834 230593
1	1	2	2	<b>Bag of accessories spring stay Alu-HKS® Z</b> 24 29	238645

Use of spring stay is essential.  
for additional gear designs, see page 38  
for additional handle designs, see page 40



# ATRIUM Alu-HKS® 200 Z

with automatic operation for sash weights of up to 160 kg

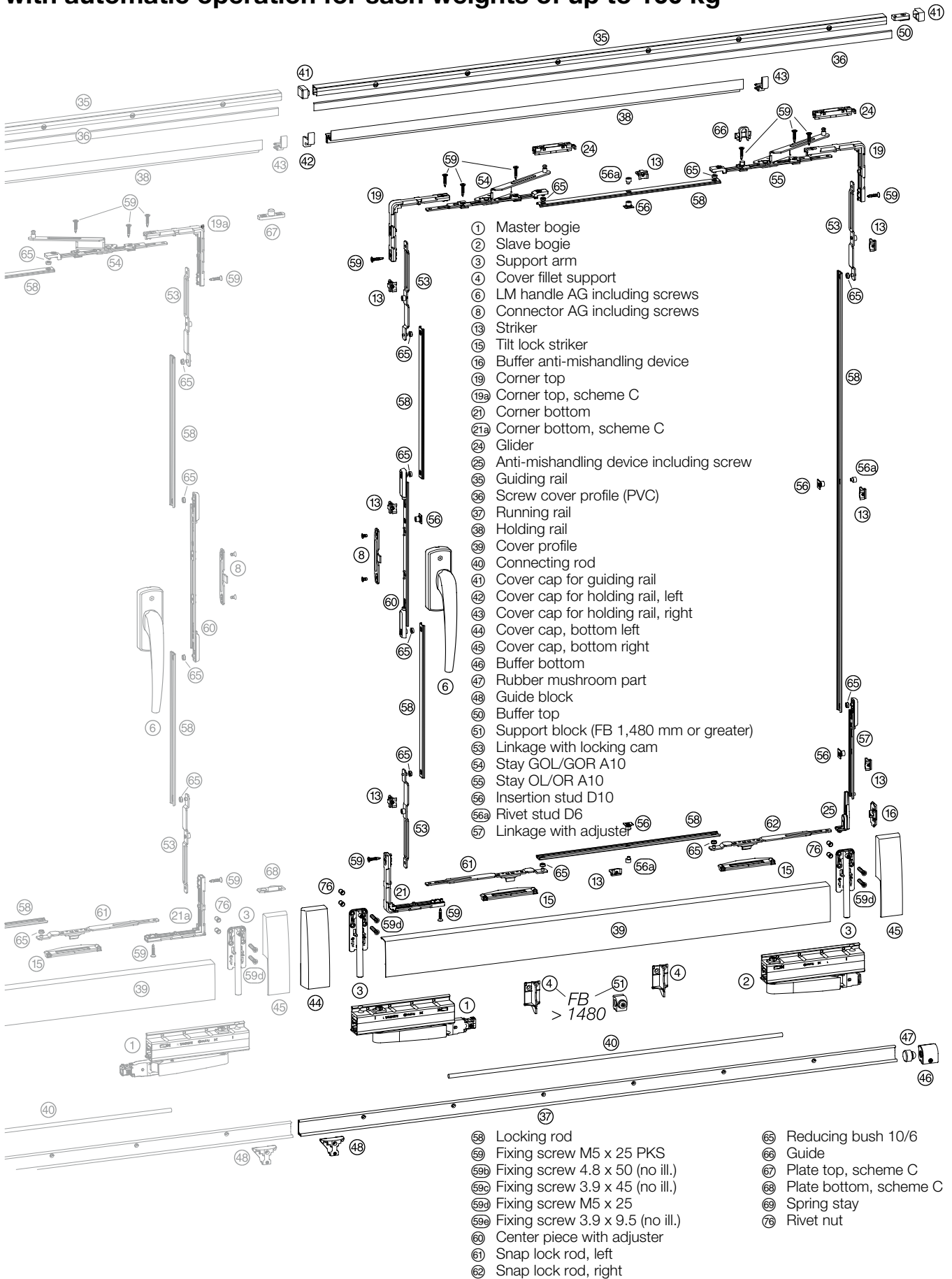



# ATRIUM Alu-HKS® 200 Z

with automatic operation for sash weights of up to 160 kg

Unit per scheme

Unit per scheme				Item name	Item code						
A	G	K	C								
1	1	2	1L 1R	<b>Carton of bogies Alu-HKS® 200</b> ① ② ④ ⑤⑨					left	230497	
									right	230494	
1	1	2	2	<b>Caps bogies, large + support arms Alu-HKS®</b> ③ ④④ ④⑤ ⑤⑨⑨ ⑦⑥	<b>silver</b>	<b>white</b>	<b>black</b>	<b>brown</b>	<b>blank</b>		
					230521	230527	230524	240418		230518	
1	1	2	1	<b>Basic carton Alu-HKS® Z</b> ⑩ ⑪ ⑫ ⑬ ⑭ ⑮ ⑯ ⑰ ⑱ ⑲ ⑳ ㉑ ㉒ ㉓ ㉔ ㉕ ㉖ ㉗ ㉘ ㉙ ㉚ ㉛ ㉜ ㉝					left	233425	
									right	233428	
			1	<b>Basic carton scheme C Alu-HKS® Z</b> ⑴⑹ ⑵⑺ ⑶⑻ ⑷⑿ ⑸⑼ ⑹⑽ ⑺⑾ ⑻⑿ ⑽⑿ ⑾⑿ ⑿⑿ ⑴⑴ ⑵⑵ ⑶⑶ ⑷⑷ ⑸⑸ ⑹⑹ ⑺⑺ ⑻⑻ ⑽⑽ ⑾⑾ ⑿⑿						right	233431
1	1	2	1L 1R	<b>LM HAUTAU design handle with AG</b> ⑥ ⑧	<b>203 AG</b>	<b>EV 1</b>	<b>white</b>	<b>black</b>	<b>brown</b>		
					left		230428	230434	230440	240173	
					right		230425	230431	230437	240170	
1	1	2	2	<b>Bag of accessory strikers (profile-related)</b> ⑬ ⑮ ⑱ ⑳ ㉑ ㉒ ㉓ ㉔ ㉕ ㉖						see striker table, page 45	
1	1	2	2	<b>Rail set Alu-HKS®</b>	<b>FB/RAB</b>	<b>silver</b>	<b>white</b>	<b>black</b>	<b>brown</b>	<b>blank</b>	
					930/1930	230536	230539	230530	238819	230533	
					1080/2230	230548	230551	230542	238822	230545	
				⑳ ㉑ ㉒ ㉓ ㉔ ㉕ ㉖ ㉗ ㉘ ㉙ ㉚ ㉛ ㉜ ㉝ ㉞ ㉟ ㊱ ㊲ ㊳ ㊴ ㊵ ㊶ ㊷ ㊸ ㊹ ㊺ ㊻ ㊼ ㊽ ㊾ ㊿	1280/2630	230560	230563	230554	238825	230557	
				also for FB 1480 or greater: ⑴	1480/3030	230572	230575	230566	238828	230569	
					1680/3430	230584	230587	230578	238831	230581	
					2000/4130	230596	230599	230590	238834	230593	
1	1	2	2	<b>Bag of accessories spring stay Alu-HKS® Z</b> ㉞ ㉟						238645	

Sash depths (FT) > 75 mm require spring stays.  
 for additional gear designs, see page 38  
 for additional handle designs, see page 40



# ATRIUM Alu-HKS® 200 Z

with automatic operation for sash weights of up to 100 kg

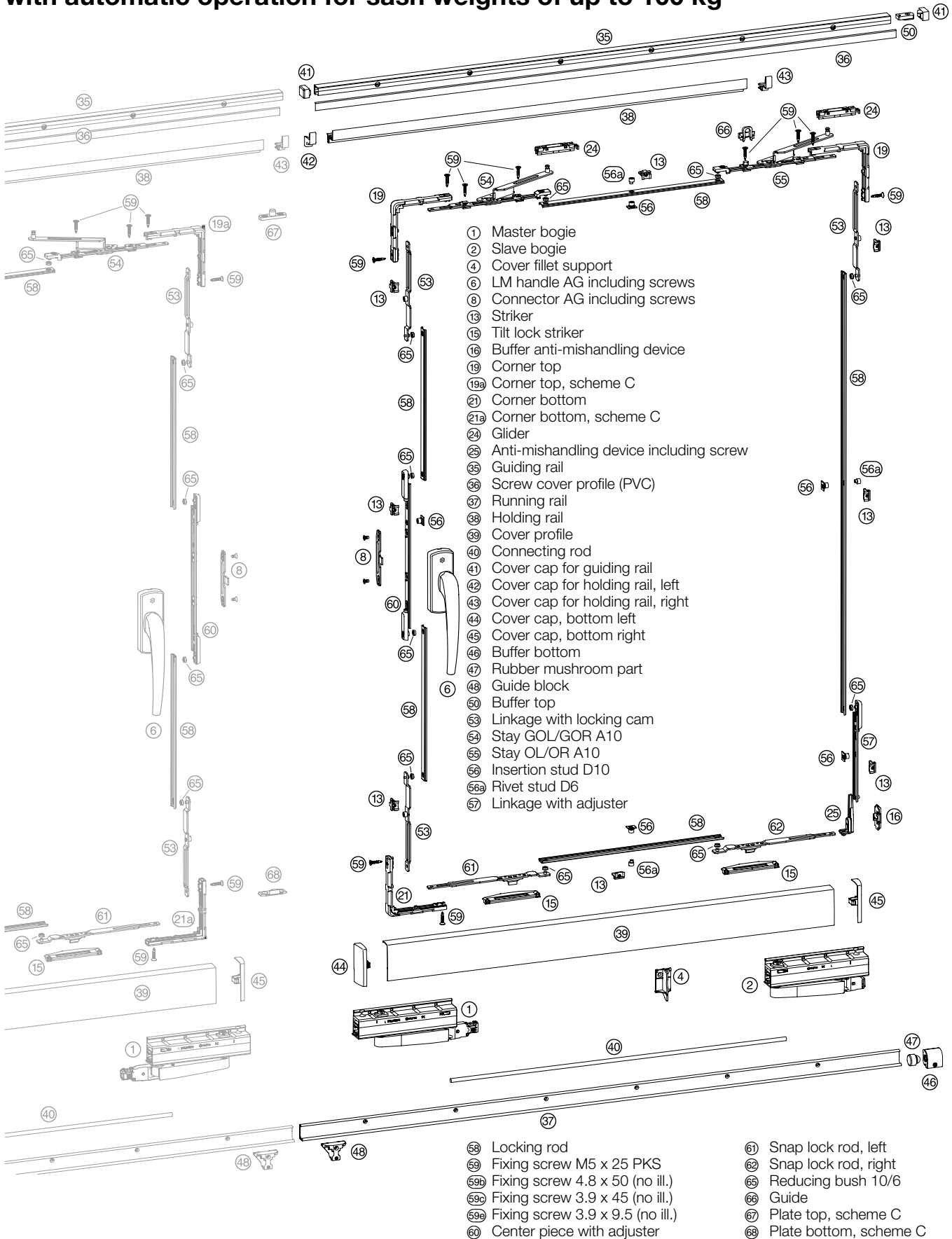

- 1 Master bogie
- 2 Slave bogie
- 4 Cover fillet support
- 6 LM handle AG including screws
- 8 Connector AG including screws
- 13 Striker
- 15 Tilt lock striker
- 16 Buffer anti-mishandling device
- 19 Corner top
- 19a Corner top, scheme C
- 21 Corner bottom
- 21a Corner bottom, scheme C
- 24 Glider
- 25 Anti-mishandling device including screw
- 35 Guiding rail
- 36 Screw cover profile (PVC)
- 37 Running rail
- 38 Holding rail
- 39 Cover profile
- 40 Connecting rod
- 41 Cover cap for guiding rail
- 42 Cover cap for holding rail, left
- 43 Cover cap for holding rail, right
- 44 Cover cap, bottom left
- 45 Cover cap, bottom right
- 46 Buffer bottom
- 47 Rubber mushroom part
- 48 Guide block
- 50 Buffer top
- 53 Linkage with locking cam
- 54 Stay GOL/GOR A10
- 55 Stay OL/OR A10
- 56 Insertion stud D10
- 56a Rivet stud D6
- 57 Linkage with adjuster

- 58 Locking rod
- 59 Fixing screw M5 x 25 PKS
- 59a Fixing screw 4.8 x 50 (no ill.)
- 59b Fixing screw 3.9 x 45 (no ill.)
- 59c Fixing screw 3.9 x 9.5 (no ill.)
- 60 Center piece with adjuster
- 61 Snap lock rod, left
- 62 Snap lock rod, right
- 63 Reducing bush 10/6
- 64 Guide
- 67 Plate top, scheme C
- 68 Plate bottom, scheme C



# ATRIUM Alu-HKS® 200 Z

with automatic operation for sash weights of up to 100 kg

Unit per scheme

A	G	K	C	Item name	Item code					
1	1	2	1L 1R	<b>Carton of bogies Alu-HKS® 200</b> ① ② ④ ⑤⑨	left	230497				
					right	230494				
1	1	2	2	<b>Caps bogies, small Alu-HKS®</b> ④④ ④⑤	<b>silver</b>	<b>white</b>	<b>black</b>	<b>brown</b>	<b>blank</b>	
					230509	230515	230512	238747	230506	
1	1	2	1	<b>Basic carton Alu-HKS® Z</b> ⑩ ⑪ ⑫ ⑬ ⑭ ⑮ ⑯ ⑰ ⑱ ⑲ ⑳ ㉑ ㉒ ㉓ ㉔ ㉕ ㉖ ㉗ ㉘ ㉙ ㉚ ㉛ ㉜ ㉝	left	233425				
					right	233428				
			1	<b>Basic carton scheme C Alu-HKS® Z</b> ⑴⑹ ⑵⑺ ⑶⑻ ⑷⑽ ⑸⑾ ⑹⑿ ⑺⓫ ⑻⓬ ⑽⓭ ⑾⓮ ⑿⓯ ⑿⓰ ⑿⓱ ⑿⓲ ⑿⓳ ⑿⓴ ⑿⓵ ⑿⓶ ⑿⓷ ⑿⓸ ⑿⓹ ⑿⓺ ⑿⓻ ⑿⓼ ⑿⓽ ⑿⓾ ⑿⓿	right	233431				
1	1	2	1L 1R	<b>LM HAUTAU design handle with AG</b> ⑥ ⑧	<b>203 AG</b>	<b>EV 1</b>	<b>white</b>	<b>black</b>	<b>brown</b>	
					left	230428	230434	230440	240173	
					right	230425	230431	230437	240170	
1	1	2	2	<b>Bag of accessory strikers (profile-related)</b> ⑬ ⑮ ⑯ ⑳ ㉑ ㉒ ㉓ ㉔ ㉕ ㉖ ㉗ ㉘ ㉙ ㉚ ㉛ ㉜ ㉝ ㉞ ㉟	see striker table, page 45					
1	1	2	2	<b>Rail set Alu-HKS®</b>	<b>FB/RAB</b>	<b>silver</b>	<b>white</b>	<b>black</b>	<b>brown</b>	<b>blank</b>
					930/1930	230536	230539	230530	238819	230533
				⑳ ㉑ ㉒ ㉓ ㉔ ㉕ ㉖ ㉗ ㉘ ㉙ ㉚ ㉛ ㉜ ㉝ ㉞ ㉟ ㊱ ㊲ ㊳ ㊴ ㊵ ㊶ ㊷ ㊸ ㊹ ㊺ ㊻ ㊼ ㊽ ㊾ ㊿	1080/2230	230548	230551	230542	238822	230545
					1280/2630	230560	230563	230554	238825	230557

for additional gear designs, see page 38  
 for additional handle designs, see page 40



# ATRIUM Alu-HKS® 160 S/10

without automatic operation for sash weights of up to 160 kg,  
locking system D10

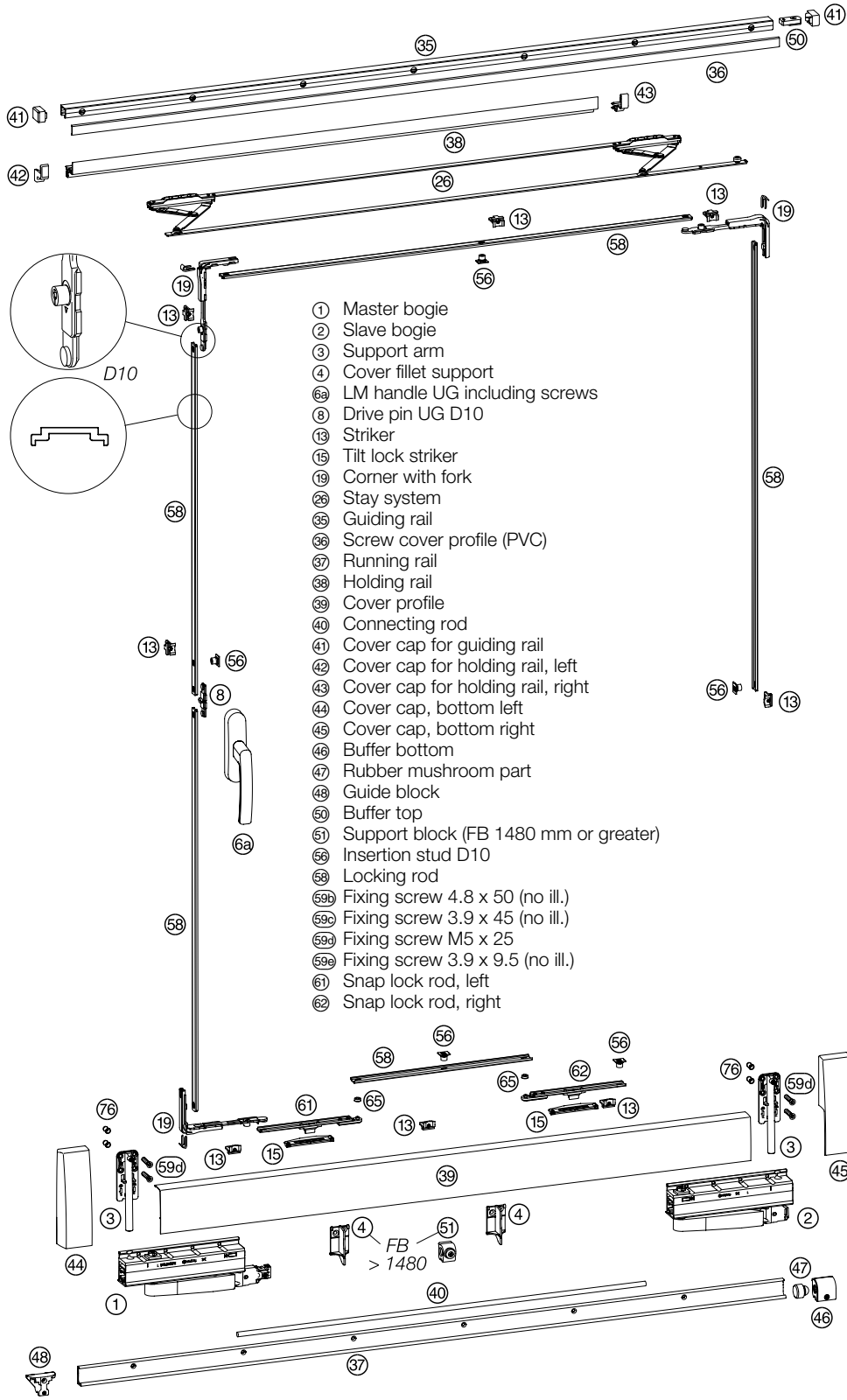

- ① Master bogie
- ② Slave bogie
- ③ Support arm
- ④ Cover fillet support
- ⑥a LM handle UG including screws
- ⑧ Drive pin UG D10
- ⑬ Striker
- ⑮ Tilt lock striker
- ⑰ Corner with fork
- ⑲ Stay system
- ⑳ Guiding rail
- ㉑ Screw cover profile (PVC)
- ㉒ Running rail
- ㉓ Holding rail
- ㉔ Cover profile
- ㉕ Connecting rod
- ㉖ Cover cap for guiding rail
- ㉗ Cover cap for holding rail, left
- ㉘ Cover cap for holding rail, right
- ㉙ Cover cap, bottom left
- ㉚ Cover cap, bottom right
- ㉛ Buffer bottom
- ㉜ Rubber mushroom part
- ㉝ Guide block
- ㉞ Buffer top
- ㉟ Support block (FB 1480 mm or greater)
- ㊱ Insertion stud D10
- ㊲ Locking rod
- ㊳ Fixing screw 4.8 x 50 (no ill.)
- ㊴ Fixing screw 3.9 x 45 (no ill.)
- ㊵ Fixing screw M5 x 25
- ㊶ Fixing screw 3.9 x 9.5 (no ill.)
- ㊷ Snap lock rod, left
- ㊸ Snap lock rod, right

- ㉞ Reducing bush 10/6
- ㊹ Rivet nut
- ㊺ LM Handle UG support





# ATRIUM Alu-HKS® 160 S/10

without automatic operation for sash weights of up to 160 kg,  
locking system D 10

Unit per scheme

A	G	K	C	Item name	Item code							
1	1	2	1L 1R	<b>Carton of bogies Alu-HKS® 200</b> ① ② ④ ⑤b	left	230497						
					right	230494						
1	1	2	2	<b>Caps bogies, large + support arms Alu-HKS®</b> ③ ④④ ④⑤ ⑤9a 7⑥	<b>silver</b>	<b>white</b>	<b>black</b>	<b>brown</b>	<b>blank</b>			
					230521	230527	230524	240418	230518			
1	1	2	2	<b>Accessories locking system Alu-HKS® S R/L D 10</b> ⑧ ①⑨ ⑤⑩ ⑤⑪							233437	
1	1	2	2	<b>Accessories snap lock rod Alu-HKS® S 15/20</b> ⑥① ⑥② ⑥③ ⑥④							234877	
1	1	2	2	<b>Stay system</b> ⑥⑤				<b>FB 930</b>	<b>FB 1280</b>	<b>FB 1680</b>		
								217140	217143	217146		
1	1	2	2	<b>LM handle HAUTAU design with gear with fork drive</b> ⑥⑥	<b>LM UG</b>	<b>silver</b>	<b>white</b>	<b>black</b>	<b>brown</b>			
						192478	192484	192481	192487			
1	1	2	2	<b>Bag of accessory strikers (profile-related)</b> ⑬ ⑮ ⑤⑫							see striker table, page 45	
1	1	2	2	<b>Rail set Alu-HKS®</b>	<b>FB/RAB</b>	<b>silver</b>	<b>white</b>	<b>black</b>	<b>brown</b>	<b>blank</b>		
					930/1930	230536	230539	230530	238819	230533		
					1080/2230	230548	230551	230542	238822	230545		
				⑤⑬ ⑤⑭ ⑤⑮ ⑤⑯ ⑤⑰ ⑤⑱ ⑤⑲ ⑤⑳ ⑤㉑ ⑤㉒ ⑤㉓ ⑤㉔ ⑤㉕ ⑤㉖ ⑤㉗ ⑤㉘ ⑤㉙ ⑤㉚ ⑤㉛ ⑤㉜ ⑤㉝ ⑤㉞ ⑤㉟ ⑤㊱ ⑤㊲	1280/2630	230560	230563	230554	238825	230557		
				Also for FB 1480 or greater: ⑤⑳	1480/3030	230572	230575	230566	238828	230569		
					1680/3430	230584	230587	230578	238831	230581		

for additional gear designs, see page 38  
for additional handle designs, see page 40



# ATRIUM Alu-HKS® 160 S/6

without automatic operation for sash weights of up to 160 kg,  
locking system D6

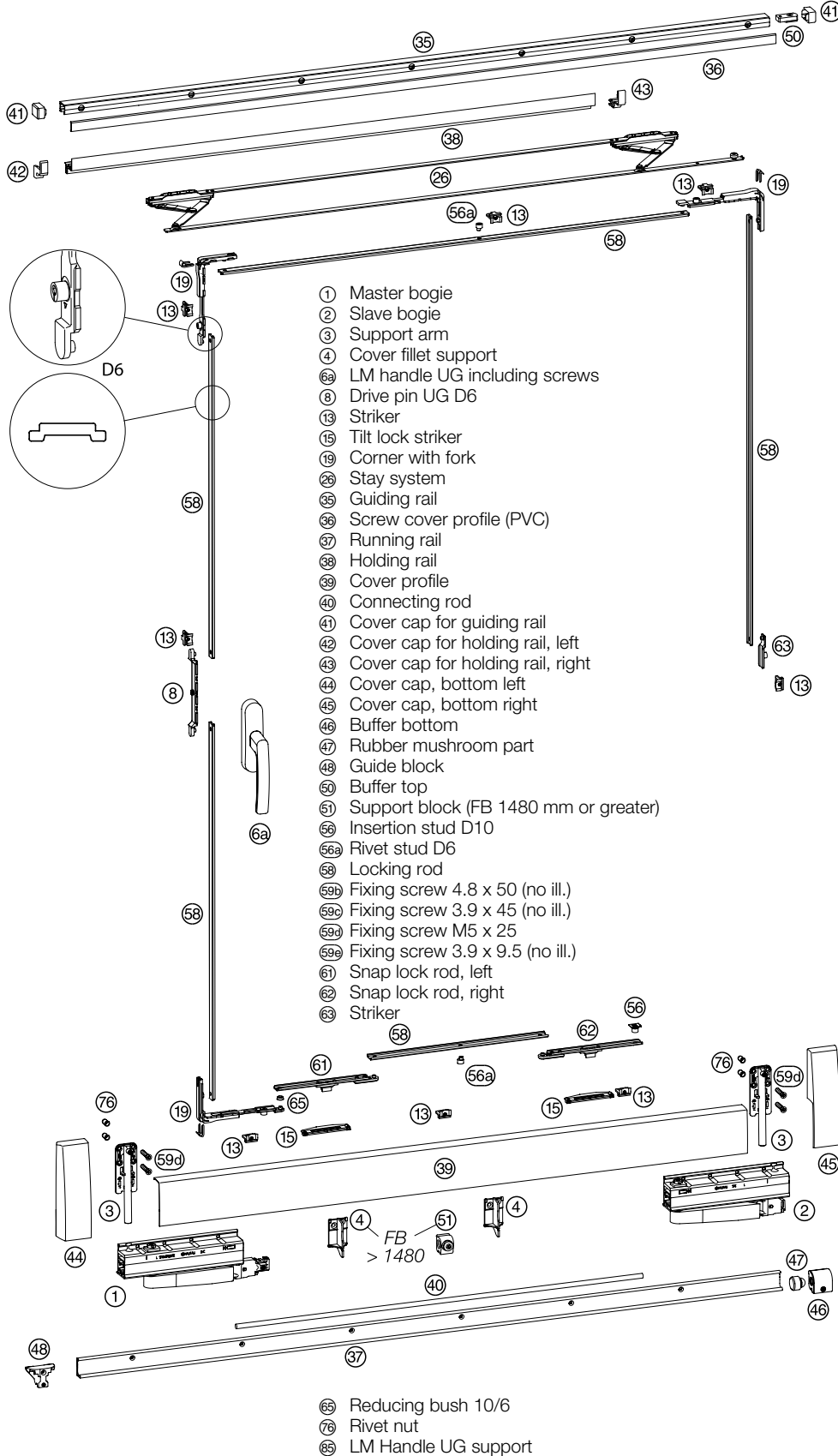



# ATRIUM Alu-HKS® 160 S/6

without automatic operation for sash weights of up to 160 kg,  
locking system D6

Unit per scheme

A	G	K	C	Item name	Item code					
1	1	2	1L 1R	<b>Carton of bogies Alu-HKS® 200</b> ① ② ④ ⑤b					left	230497
									right	230494
1	1	2	2	<b>Caps bogies, large + support arms Alu-HKS®</b> ③ ④④ ④⑤ ⑤9a 76	<b>silver</b>	<b>white</b>	<b>black</b>	<b>brown</b>	<b>blank</b>	
					230521	230527	230524	240418	230518	
1	1	2	2	<b>Accessories locking system Alu-HKS® S R/L D 6</b> ⑧ ⑩ ⑩③ ⑩⑤						233434
1	1	2	2	<b>Accessories snap lock rod Alu-HKS® S 15/20</b> ⑥① ⑥② ⑥⑤ ⑥⑥						234877
1	1	2	2	<b>Stay system</b> ⑥⑧			<b>FB 930</b>	<b>FB 1280</b>	<b>FB 1680</b>	
							217140	217143	217146	
1	1	2	2	<b>LM handle HAUTAU design with gear with fork drive</b> ⑥⑨	<b>LM UG</b>	<b>silver</b>	<b>white</b>	<b>black</b>	<b>brown</b>	
						192478	192484	192481	192487	
1	1	2	2	<b>Bag of accessory strikers (profile-related)</b> ⑩③ ⑩⑤ ⑩⑥a						see striker table, page 45
1	1	2	2	<b>Rail set Alu-HKS®</b>	<b>FB/RAB</b>	<b>silver</b>	<b>white</b>	<b>black</b>	<b>brown</b>	<b>blank</b>
					930/1930	230536	230539	230530	238819	230533
					1080/2230	230548	230551	230542	238822	230545
				③⑤ ③⑥ ③⑦ ③⑧ ③⑨ ④① ④② ④③ ④⑥ ④⑦ ④⑧ ⑤① ⑤②c ⑤②e	1280/2630	230560	230563	230554	238825	230557
				Also for FB 1480 or greater: ⑤①	1480/3030	230572	230575	230566	238828	230569
					1680/3430	230584	230587	230578	238831	230581

for additional gear designs, see page 38  
for additional handle designs, see page 40



# ATRIUM Alu-HKS® 160 S/10

without automatic operation for sash weights of up to 100 kg,  
locking system D10

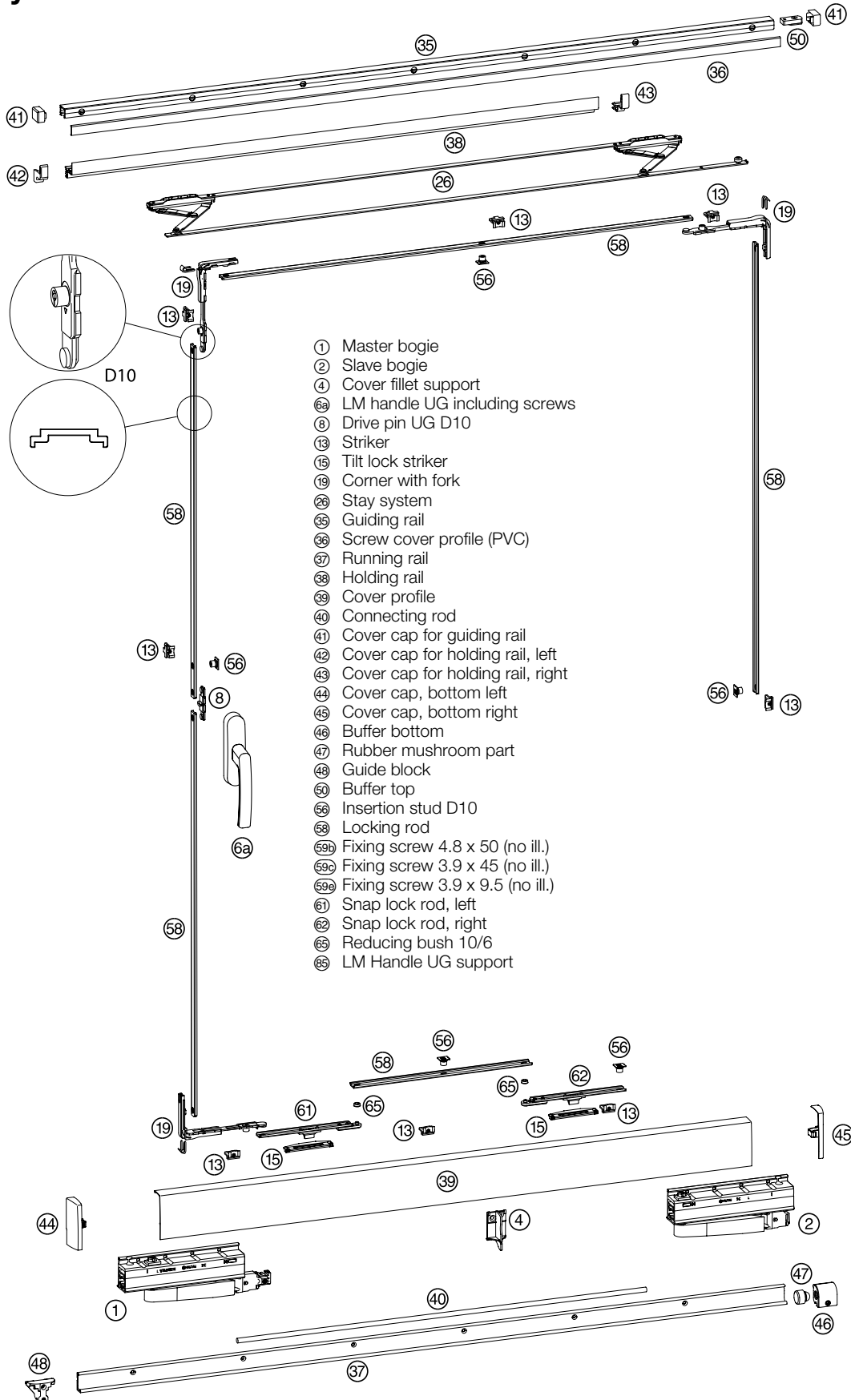

- ① Master bogie
- ② Slave bogie
- ④ Cover fillet support
- ⑥a LM handle UG including screws
- ⑧ Drive pin UG D10
- ⑬ Striker
- ⑮ Tilt lock striker
- ⑰ Corner with fork
- ⑳ Stay system
- ㉓ Guiding rail
- ㉔ Screw cover profile (PVC)
- ㉕ Running rail
- ㉖ Holding rail
- ㉗ Cover profile
- ㉘ Connecting rod
- ㉙ Cover cap for guiding rail
- ㉚ Cover cap for holding rail, left
- ㉛ Cover cap for holding rail, right
- ㉜ Cover cap, bottom left
- ㉝ Cover cap, bottom right
- ㉞ Buffer bottom
- ㉟ Rubber mushroom part
- ㊱ Guide block
- ㊲ Buffer top
- ㊳ Insertion stud D10
- ㊴ Locking rod
- ㊵a Fixing screw 4.8 x 50 (no ill.)
- ㊵b Fixing screw 3.9 x 45 (no ill.)
- ㊵c Fixing screw 3.9 x 9.5 (no ill.)
- ㊶ Snap lock rod, left
- ㊷ Snap lock rod, right
- ㊸ Reducing bush 10/6
- ㊹ LM Handle UG support



# ATRIUM Alu-HKS® 160 S/10

without automatic operation for sash weights of up to 100 kg,  
locking system D 10

Unit per scheme

A	G	K	C	Item name	Item code					
1	1	2	1L 1R	<b>Carton of bogies Alu-HKS® 200</b> ① ② ④ ⑤b					left	230497
									right	230494
1	1	2	2	<b>Caps bogies, small Alu-HKS®</b> ④③ ④⑤	<b>silver</b> 230509	<b>white</b> 230515	<b>black</b> 230512	<b>brown</b> 238747	<b>blank</b> 230506	
1	1	2	2	<b>Accessories locking system Alu-HKS® S R/L D 10</b> ⑧ ⑨ ⑩ ⑪ ⑫						233437
1	1	2	2	<b>Accessories snap lock rod Alu-HKS® S 15/20</b> ①① ①② ①③ ①④						234877
1	1	2	2	<b>Stay system</b> ①⑤			<b>FB 930</b> 217140	<b>FB 1280</b> 217143	<b>FB 1680</b> 217146	
1	1	2	2	<b>LM handle HAUTAU design with gear with fork drive</b> ①⑥	<b>LM UG</b>	<b>silver</b> 192478	<b>white</b> 192484	<b>black</b> 192481	<b>brown</b> 192487	
1	1	2	2	<b>Bag of accessory strikers (profile-related)</b> ①⑦ ①⑧ ①⑨			see striker table, page 45			
1	1	2	2	<b>Rail set Alu-HKS®</b>	<b>FB/RAB</b>	<b>silver</b>	<b>white</b>	<b>black</b>	<b>brown</b>	<b>blank</b>
				②⑤ ②⑥ ②⑦ ②⑧ ②⑨ ③① ③② ③③ ③④ ③⑤ ③⑥ ③⑦ ③⑧ ③⑨ ④① ④② ④③ ④④ ④⑤ ④⑥ ④⑦ ④⑧ ④⑨ ⑤① ⑤② ⑤③ ⑤④ ⑤⑤	930/1930	230536	230539	230530	238819	230533
					1080/2230	230548	230551	230542	238822	230545
					1280/2630	230560	230563	230554	238825	230557

for additional gear designs, see page 38  
for additional handle designs, see page 40



# ATRIUM Alu-HKS® 160 S/6

without automatic operation for sash weights of up to 100 kg,  
locking system D6

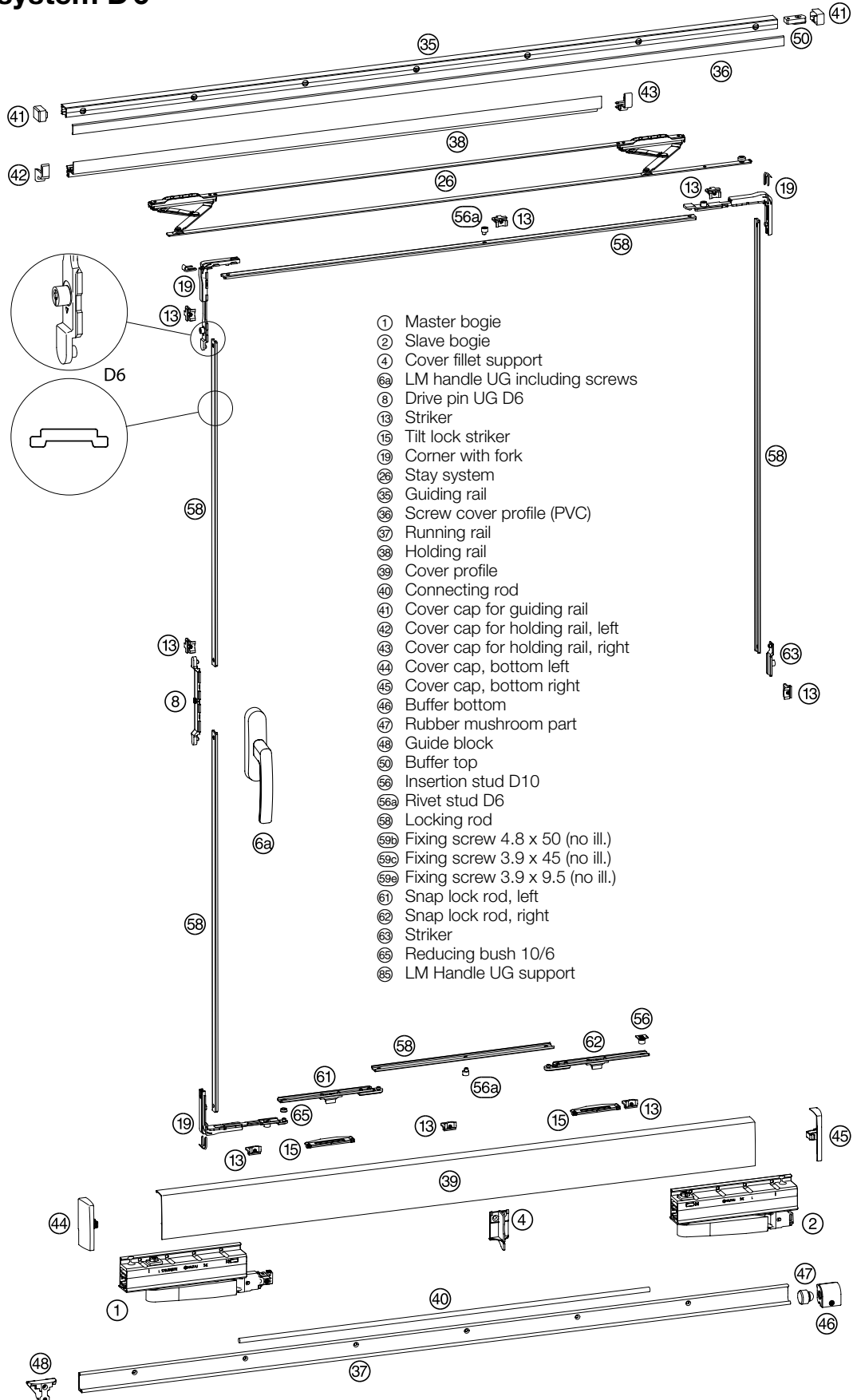

- ① Master bogie
- ② Slave bogie
- ④ Cover fillet support
- ⑥ LM handle UG including screws
- ⑧ Drive pin UG D6
- ⑬ Striker
- ⑮ Tilt lock striker
- ⑰ Corner with fork
- ⑲ Stay system
- ⑳ Guiding rail
- ㉑ Screw cover profile (PVC)
- ㉒ Running rail
- ㉓ Holding rail
- ㉔ Cover profile
- ㉕ Connecting rod
- ㉖ Cover cap for guiding rail
- ㉗ Cover cap for holding rail, left
- ㉘ Cover cap for holding rail, right
- ㉙ Cover cap, bottom left
- ㉚ Cover cap, bottom right
- ㉛ Buffer bottom
- ㉜ Rubber mushroom part
- ㉝ Guide block
- ㉞ Buffer top
- ㉟ Insertion stud D10
- ㊱ Rivet stud D6
- ㊲ Locking rod
- ㊳ Fixing screw 4.8 x 50 (no ill.)
- ㊴ Fixing screw 3.9 x 45 (no ill.)
- ㊵ Fixing screw 3.9 x 9.5 (no ill.)
- ㊶ Snap lock rod, left
- ㊷ Snap lock rod, right
- ㊸ Striker
- ㊹ Reducing bush 10/6
- ㊺ LM Handle UG support



# ATRIUM Alu-HKS® 160 S/6

without automatic operation for sash weights of up to 100 kg,  
locking system D6

Unit per scheme

A	G	K	C	Item name	Item code					
1	1	2	1L 1R	<b>Carton of bogies Alu-HKS® 200</b> ① ② ④ ⑤b	left		230497			
					right		230494			
1	1	2	2	<b>Caps bogies, small Alu-HKS®</b> ④③ ④⑤	<b>silver</b> 230509	<b>white</b> 230515	<b>black</b> 230512	<b>brown</b> 238747	<b>blank</b> 230506	
1	1	2	2	<b>Accessories locking system Alu-HKS® S R/L D 6</b> ⑧ ⑩ ⑬ ⑭ ⑮	233434					
1	1	2	2	<b>Accessories snap lock rod Alu-HKS® S 15/20</b> ⑥① ⑥② ⑥⑤ ⑥⑥	234877					
1	1	2	2	<b>Stay system</b> ②⑥	<b>FB 930</b> 217140		<b>FB 1280</b> 217143	<b>FB 1680</b> 217146		
1	1	2	2	<b>LM handle HAUTAU design with gear with fork drive</b> ⑥⑨	<b>LM UG</b>	<b>silver</b> 192478	<b>white</b> 192484	<b>black</b> 192481	<b>brown</b> 192487	
1	1	2	2	<b>Bag of accessory strikers (profile-related)</b> ⑬ ⑮ ⑮a	see striker table, page 45					
1	1	2	2	<b>Rail set Alu-HKS®</b>	<b>FB/RAB</b>	<b>silver</b>	<b>white</b>	<b>black</b>	<b>brown</b>	<b>blank</b>
				③⑤ ③⑥ ③⑦ ③⑧ ③⑨ ④① ④② ④③ ④④ ④⑤ ④⑥ ④⑦ ④⑧ ⑤① ⑤②a ⑤②b	930/1930	230536	230539	230530	238819	230533
					1080/2230	230548	230551	230542	238822	230545
					1280/2630	230560	230563	230554	238825	230557

for additional gear designs, see page 38  
for additional handle designs, see page 40



# ATRIUM Alu-HKS® 160 S o.v.

without automatic operation for sash weights of up to 160 kg,  
different locking system

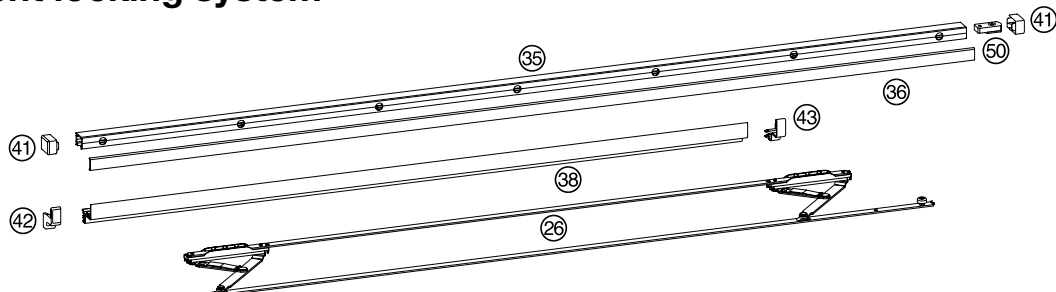

- ① Master bogie
- ② Slave bogie
- ③ Support arm
- ④ Cover fillet support
- ⑮ Tilt lock striker
- ⑳ Stay system
- ㉑ Stay system
- ㉒ Guiding rail
- ㉓ Screw cover profile (PVC)
- ㉔ Running rail
- ㉕ Holding rail
- ㉖ Cover profile
- ㉗ Connecting rod
- ㉘ Cover cap for guiding rail
- ㉙ Cover cap for holding rail, left
- ㉚ Cover cap for holding rail, right
- ㉛ Cover cap, bottom left
- ㉜ Cover cap, bottom right
- ㉝ Buffer bottom
- ㉞ Rubber mushroom part
- ㉟ Guide block
- ㊱ Buffer top
- ㊲ Support block (FB 1480 mm or greater)
- ㊳ Insertion stud D10
- ㊴ Fixing screw 4.8 x 50 (no ill.)
- ㊵ Fixing screw 3.9 x 45 (no ill.)
- ㊶ Fixing screw M5 x 25
- ㊷ Fixing screw 3.9 x 9.5 (no ill.)
- ㊸ Snap lock rod, left
- ㊹ Snap lock rod, right
- ㊺ Reducing bush 10/6
- ㊻ Rivet nut

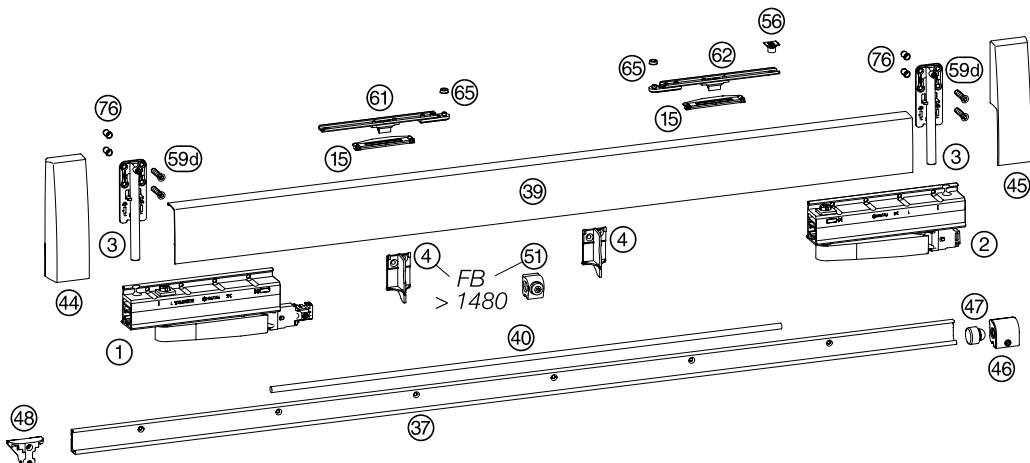





# ATRIUM Alu-HKS® 160 S o.V.

without automatic operation for sash weights of up to 160 kg,  
different locking system

Unit per scheme

A	G	K	C	Item name	Item code							
1	1	2	1L 1R	<b>Carton of bogies Alu-HKS® 200</b> ① ② ④ ⑤b						left	230497	
										right	230494	
1	1	2	2	<b>Caps bogies, large + support arms Alu-HKS®</b> ③ ④④ ④⑤ ⑤9a 76	<b>silver</b> 230521	<b>white</b> 230527	<b>black</b> 230524	<b>brown</b> 240418	<b>blank</b> 230518			
1	1	2	2	<b>Accessories snap lock rod Alu-HKS® S 15/20</b> ⑥1 ⑥2 ⑥5 ⑥5								234877
1	1	2	2	<b>Stay system</b> ⑥6			<b>FB 930</b> 217140	<b>FB 1280</b> 217143	<b>FB 1680</b> 217146			
1	1	2	2	<b>Bag of accessory strikers (profile-related)</b> ⑥9	see striker table, page 45							
1	1	2	2	<b>Rail set Alu-HKS®</b>	<b>FB/RAB</b> 930/1930	<b>silver</b> 230536	<b>white</b> 230539	<b>black</b> 230530	<b>brown</b> 238819	<b>blank</b> 230533		
					1080/2230	230548	230551	230542	238822	230545		
				⑥5 ⑥6 ⑥7 ⑥8 ⑥9 ④0 ④1 ④2 ④3 ④6 ④7 ④8 ⑤0 ⑤9c ⑤9e	1280/2630	230560	230563	230554	238825	230557		
				Also for FB 1480 or greater: ⑥1	1480/3030	230572	230575	230566	238828	230569		
					1680/3430	230584	230587	230578	238831	230581		

for additional gear designs, see page 38  
for additional handle designs, see page 40



# ATRIUM Alu-HKS® 160 S o.V.

without automatic operation for sash weights of up to 100 kg,  
different locking system

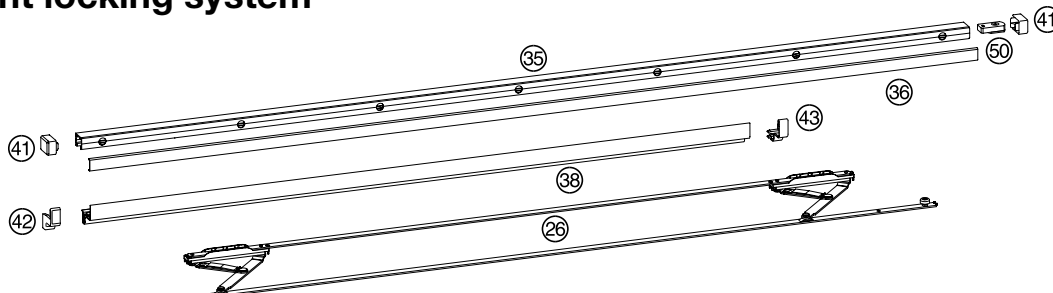

- ① Master bogie
- ② Slave bogie
- ④ Cover fillet support
- ⑮ Tilt lock striker
- ⑲ Stay system
- ⑳ Guiding rail
- ㉑ Guiding rail
- ㉒ Screw cover profile (PVC)
- ㉓ Running rail
- ㉔ Holding rail
- ㉕ Cover profile
- ㉖ Connecting rod
- ㉗ Cover cap for guiding rail
- ㉘ Cover cap for holding rail, left
- ㉙ Cover cap for holding rail, right
- ㉚ Cover cap, bottom left
- ㉛ Cover cap, bottom right
- ㉜ Buffer bottom
- ㉝ Rubber mushroom part
- ㉞ Guide block
- ㉟ Buffer top
- ㊱ Insertion stud D10
- ㊲ Fixing screw 4.8 x 50 (no ill.)
- ㊳ Fixing screw 3.9 x 45 (no ill.)
- ㊴ Fixing screw 3.9 x 9.5 (no ill.)
- ㊵ Snap lock rod, left
- ㊶ Snap lock rod, right
- ㊷ Reducing bush 10/6

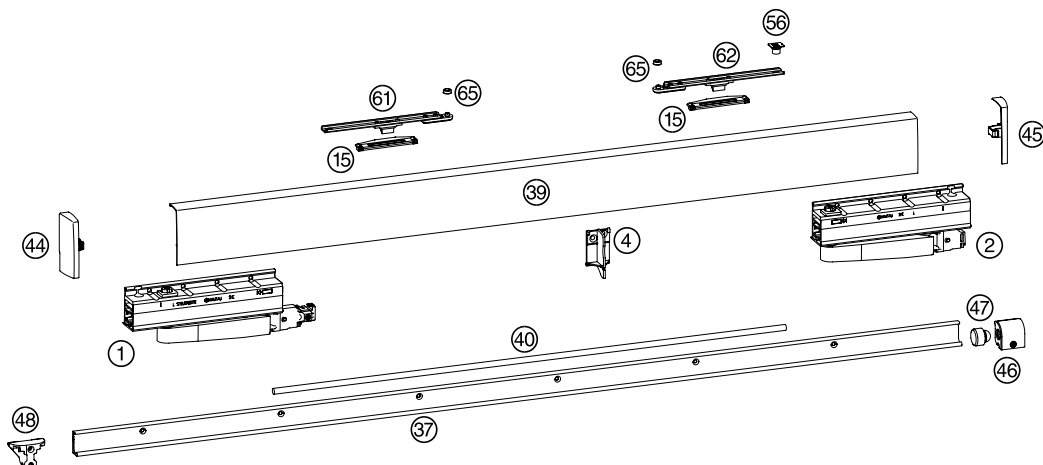



# ATRIUM Alu-HKS® 160 S o.v.

without automatic operation for sash weights of up to 100 kg,  
different locking system

Unit per scheme

A	G	K	C	Item name	Item code					
1	1	2	1L 1R	<b>Carton of bogies Alu-HKS® 200</b> ① ② ④ ⑤b					left	230497
									right	230494
1	1	2	2	<b>Caps bogies, small Alu-HKS®</b> ④③ ④⑤	<b>silver</b> 230509	<b>white</b> 230515	<b>black</b> 230512	<b>brown</b> 238747	<b>blank</b> 230506	
1	1	2	2	<b>Accessories snap lock rod Alu-HKS® S 15/20</b> ⑥① ⑥② ⑥⑤ ⑥⑥						234877
1	1	2	2	<b>Stay system</b> ⑥⑧			<b>FB 930</b> 217140	<b>FB 1280</b> 217143	<b>FB 1680</b> 217146	
1	1	2	2	<b>Bag of accessory strikers (profile-related)</b> ⑥⑨			see striker table, page 45			
1	1	2	2	<b>Rail set Alu-HKS®</b>	<b>FB/RAB</b> 930/1930	<b>silver</b> 230536	<b>white</b> 230539	<b>black</b> 230530	<b>brown</b> 238819	<b>blank</b> 230533
				③⑤ ③⑥ ③⑦ ③⑧ ③⑨ ④① ④② ④③ ④④ ④⑤ ④⑥ ④⑦ ④⑧ ⑤① ⑤② ⑤③ ⑤④	1080/2230	230548	230551	230542	238822	230545
					1280/2630	230560	230563	230554	238825	230557

for additional gear designs, see page 38  
for additional handle designs, see page 40



# ATRIUM Alu-HKS® 160 S/RC2

without automatic operation for sash weights of up to 160 kg, design RC2

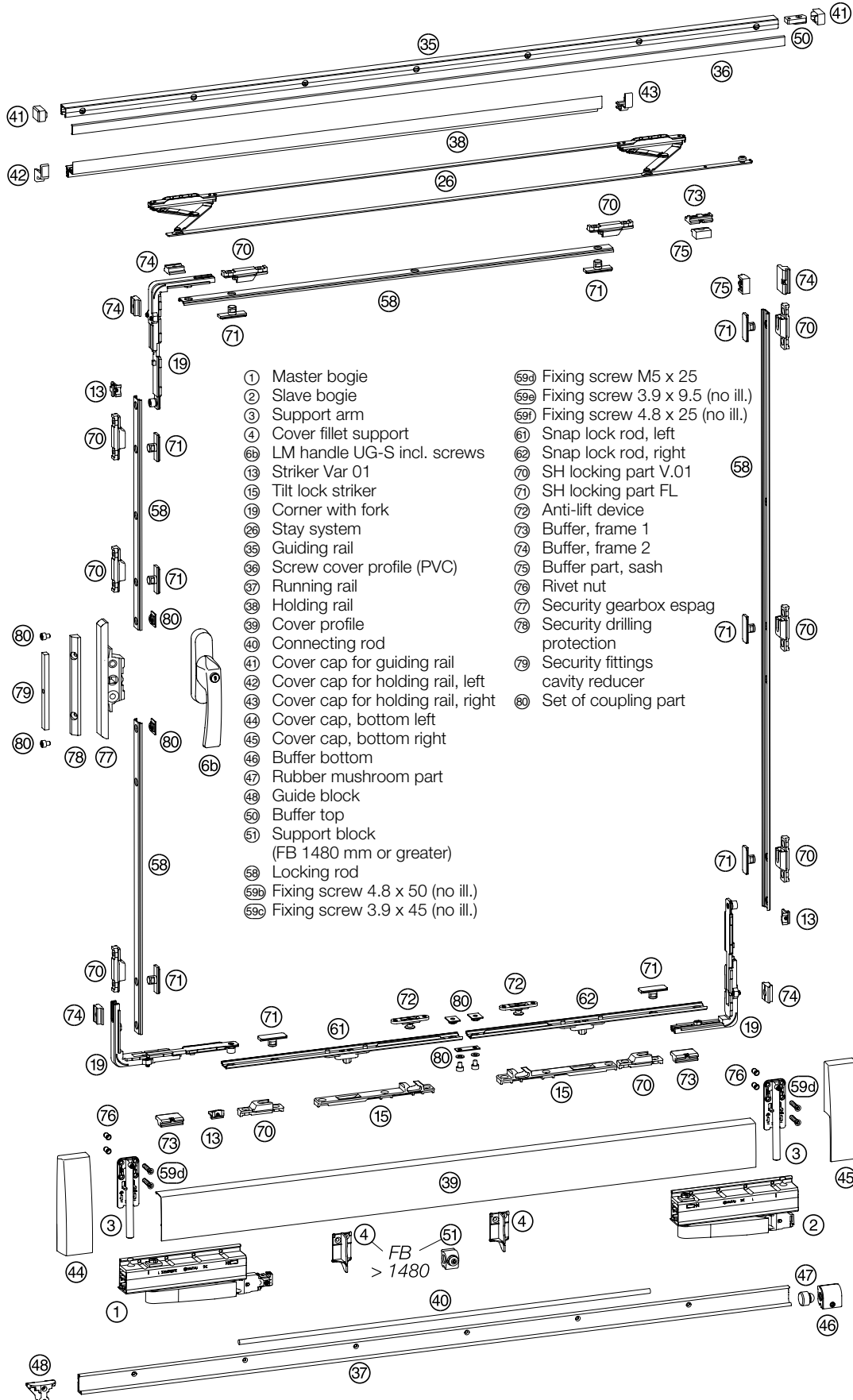

- |  |                                      |
|--|--------------------------------------|
| ① Master bogie                           | ⑤⑨d Fixing screw M5 x 25             |
| ② Slave bogie                            | ⑤⑨e Fixing screw 3.9 x 9.5 (no ill.) |
| ③ Support arm                            | ⑤⑨f Fixing screw 4.8 x 25 (no ill.)  |
| ④ Cover fillet support                   | ⑥① Snap lock rod, left               |
| ⑥ LM handle UG-S incl. screws            | ⑥② Snap lock rod, right              |
| ⑬ Striker Var 01                         | ⑦⑦ SH locking part V.01              |
| ⑮ Tilt lock striker                      | ⑦① SH locking part FL                |
| ⑲ Corner with fork                       | ⑦② Anti-lift device                  |
| ⑳ Stay system                            | ⑦③ Buffer, frame 1                   |
| ㉓ Guiding rail                           | ⑦④ Buffer, frame 2                   |
| ㉔ Screw cover profile (PVC)              | ⑦⑤ Buffer part, sash                 |
| ㉕ Running rail                           | ⑦⑥ Rivet nut                         |
| ㉖ Holding rail                           | ⑦⑦ Security gearbox espag            |
| ㉗ Cover profile                          | ⑦⑧ Security drilling protection      |
| ④① Connecting rod                        | ⑦⑨ Security fittings cavity reducer  |
| ④② Cover cap for guiding rail            | ⑧① Set of coupling part              |
| ④③ Cover cap for holding rail, left      |                                      |
| ④④ Cover cap for holding rail, right     |                                      |
| ④⑤ Cover cap, bottom left                |                                      |
| ④⑥ Cover cap, bottom right               |                                      |
| ④⑦ Buffer bottom                         |                                      |
| ④⑧ Rubber mushroom part                  |                                      |
| ④⑨ Guide block                           |                                      |
| ⑤① Buffer top                            |                                      |
| ⑤② Support block (FB 1480 mm or greater) |                                      |
| ⑤③ Locking rod                           |                                      |
| ⑤④ Fixing screw 4.8 x 50 (no ill.)       |                                      |
| ⑤⑤ Fixing screw 3.9 x 45 (no ill.)       |                                      |



# ATRIUM Alu-HKS® 160 S/RC2

without automatic operation for sash weights of up to 160 kg, design RC2

**Unit per scheme**

A	G	K	Item name	Item code					
1	1	2	<b>Carton of bogies Alu-HKS® 200</b> ① ② ④ ⑤⑨	left	230497				
				right	230494				
1	1	2	<b>Caps bogies, large + support arms Alu-HKS®</b> ③ ④④ ④⑤ ⑤⑨⑩ ⑦⑥	<b>silver</b>	<b>white</b>	<b>black</b>	<b>brown</b>	<b>blank</b>	
				230521	230527	230524	240418	230518	
1	1	2	<b>Basic carton Alu-HKS® S/RC2</b> ⑱ ⑤⑨⑩ ⑦⑥ ⑦⑦ ⑦⑧ ⑦⑨ ⑧⑩	left/right				234880	
1	1	2	<b>LM handle HAUTAU design with gear with fork</b> ⑥⑨	<b>LM UG-S</b>		<b>silver</b>	<b>white</b>	<b>black</b>	
						194972	194978	194981	
1	1	2	<b>Horizontal locking Alu-HKS® 160 S/RC2</b> ②⑥ ⑤⑨⑩ ⑥① ⑥② ⑦② ⑧⑩	FB	850 - 930			204601	
				FB	931 - 1280			204604	
				FB	1281 - 1680			204607	
1	1	2	<b>Bag of accessory strikers (profile-related)</b> ⑬ ⑮ ⑯ ⑰ ⑱ ⑲ ⑳ ㉑	<b>10 groove</b>	<b>12 groove</b>	<b>14 groove</b>			
				207160	207157	205252			
1	1	2	<b>Bag of accessory security locking parts</b> supplementing the Accessories locking parts according to sash size ⑦⑩ ⑦①						206122
1	1	2	<b>Rail set Alu-HKS®</b> ③⑤ ③⑥ ③⑦ ③⑧ ③⑨ ④① ④② ④③ ④④ ④⑤ ④⑥ ④⑦ ④⑧ ④⑨ ⑤① ⑤② ⑤③ ⑤④	<b>FB/RAB</b>	<b>silver</b>	<b>white</b>	<b>black</b>	<b>brown</b>	<b>blank</b>
				930/1930	230536	230539	230530	238819	230533
				1080/2230	230548	230551	230542	238822	230545
				1280/2630	230560	230563	230554	238825	230557
			Also for FB 1480 or greater: ⑤①	1480/3030	230572	230575	230566	238828	230569
				1680/3430	230584	230587	230578	238831	230581
1	1	2	<b>Set of security locking rods 19.5 x 4.5</b> ⑥⑧	<b>FB/RAB</b>				<b>EV1</b>	
				1680/2380				204610	

for additional gear designs, see page 38  
for additional handle designs, see page 40

## Determining the locking positions

<b>FB</b>	<b>locking positions</b>	+	<b>FH</b>	<b>locking positions</b>
850 - 930 mm	4 x		1700 - 1900 mm	6 x
931 - 1680 mm	6 x		1901 - 2380 mm	8 x

The accessory strikers include 10 locking positions



# Gear types ATRIUM Alu-HKS®

## Alu-HKS® 200 Z

EG

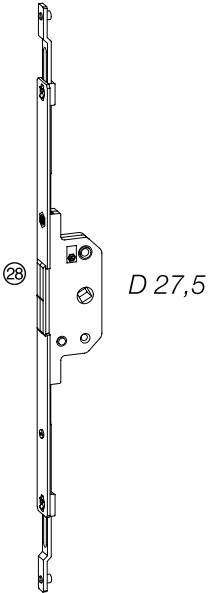

EG-Pz

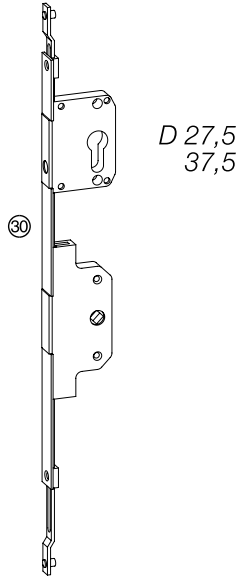

## Alu-HKS® 160 S

EG

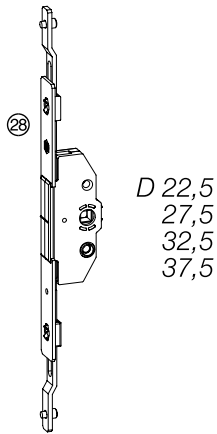

EG-Pz

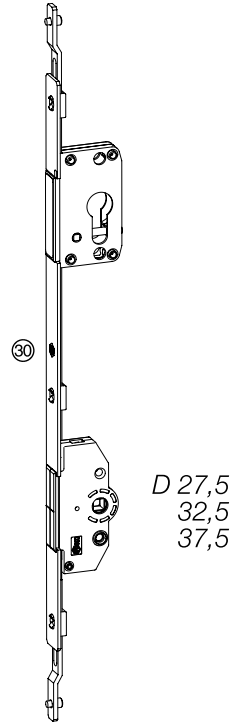

- ⊗ Espag EG
- ⓪ Espag EG, lockable
- Ⓜ Screw 3.9 x 22
- Ⓟ Reducing bush 10/6



## Gear types ATRIUM Alu-HKS®

### Alu-HKS® 200 Z

Item name	Backset	Item code
Espag ZL ⑳	D 27,5	240523
Espag ZL	D 27.5	148402
lockable ㉑	D 37.5	149194

### Alu-HKS® 160 S

Item name	Backset	Item code
Gearbox espag S and S o.V. (different locking system) ㉒	D 22.5	161167
	D 27.5	175392
	D 32.5	176331
	D 37.5	176334
Gearbox espag S and S o.V. (different locking system), lockable ㉓	D 27.5	148420
	D 32.5	156524
	D 37.5	148423
Bag of accessory Alu-HKS gearbox espag ㉔ ㉕		221882
Bag of accessory Alu-HKS reducing bushes 10/6 ㉖ (10 pcs.)		232732



# Handles ATRIUM Alu-HKS®

## Alu-HKS® 200 Z

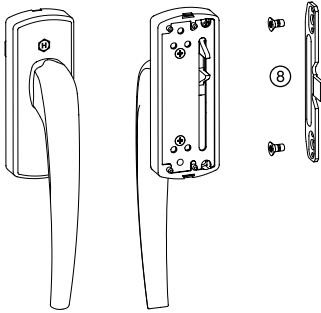

⑥ HAUTAU design handle  
203 AG

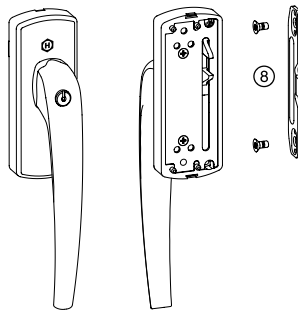

⑦ HAUTAU design handle  
203 AG-S

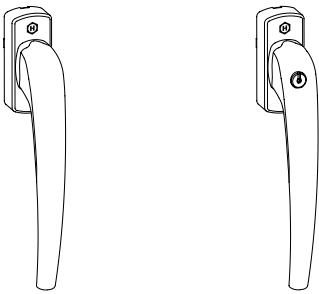

⑨ HAUTAU design handle  
201 EG



⑩ HAUTAU design handle  
201 EG-S

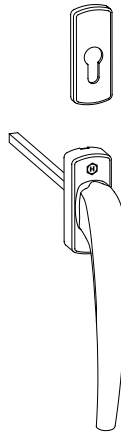

⑪ HAUTAU design handle  
201 EG-Pzl

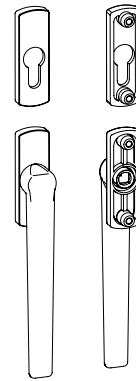

⑫ HAUTAU design handle  
201 EG-PzA\*

## Alu-HKS® 160 S

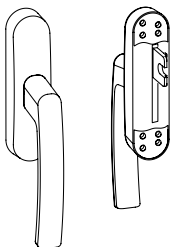

⑥a HAUTAU design handle  
UG

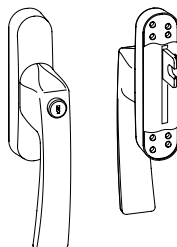

⑥b HAUTAU design handle  
UG-S



⑪a HAUTAU design handle  
161 EG-Pzl

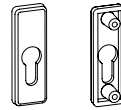

⑫a HAUTAU design handle  
160 EG-PzA\*



⑨a HAUTAU design handle  
161 EG



⑩a HAUTAU design handle  
161 EG-S



⑪a HAUTAU design handle  
161 EG-Pzl

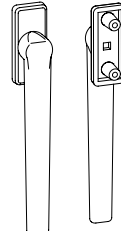

⑫a HAUTAU design handle  
160 EG-PzA\*





## Handles ATRIUM Alu-HKS®

### Alu-HKS® 200 Z

Item name			Item code				
			blank	EV 1	white	black	brown
LM handle HAUTAU design including gear with fork drive	203 AG ⑥	left	230446	230428	230434	230440	240173
		right	230443	230425	230431	230437	240170
	203 AG-S ⑦	left		230464	230470	230476	240179
		right		230461	230467	230473	240176
LM handle HAUTAU design for gearbox espag right/left			EV 1	white	black	brown	F9
	201 EG ⑨		170747	170741	170744	219963	170753
	201 EG-S ⑩		170762	170756	170759	219957	170768
	201 EG-Pzl ⑪		170798	170792	170795	219951	170801
	201 EG-PzA* ⑫		170789	170783	170786	219969	177018
<b>Spare Key</b> for handle 203 AG-S and 201 EG-S							176805

\* Range of application: max. sash profile depth (FT): 90 mm

### Alu-HKS® 160 S

Item name			Item code			
			silver	white	black	brown
LM handle HAUTAU design including gear with fork drive		LM UG ⑬	192478	192484	192481	192487
		LM UG-S ⑭	194972	194978	194981	194975
LM handle HAUTAU design for gearbox espag			EV 1	white	black	brown
		161 EG ⑮	206206	206209	206212	207361
	161 EG-S ⑯	206215	206218	206221	207367	
LM handle HAUTAU design for lockable gearbox espags			EV 1	white	black	brown
		161 EG Pzl ⑰	206224	206227	206230	207364
	160 EG PzA* ⑱	163272	163275	178090	163278	

\* Range of application: max. sash profile depth (FT): 90 mm

## Profiles in stock lengths / accessories

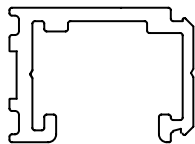

③⑤ Guiding rail



③⑥ Screw cover profile (PVC)

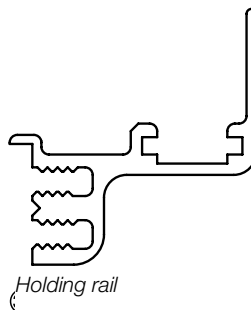

Holding rail

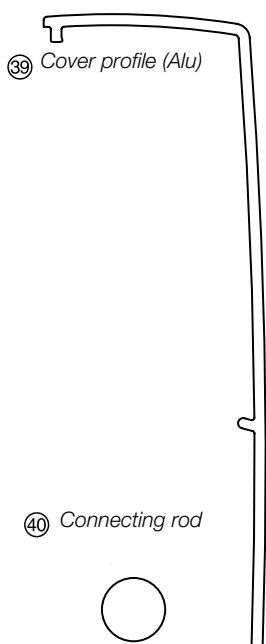

③⑨ Cover profile (Alu)

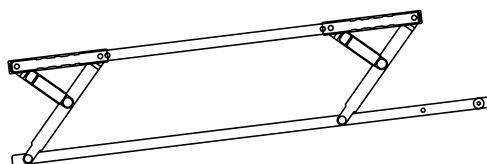

②⑥ Stay system

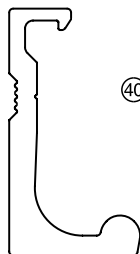

④① Connecting rod

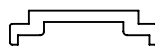

⑤⑧ Locking rod

③⑦ Running rail

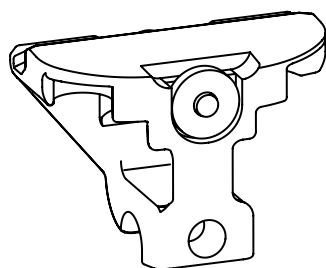

④⑨ Guide block, movable



④④ Cover cap bottom left  
④⑤ Cover cap bottom right

Accessory rail set



## Profiles in stock lengths / accessories

Item name		Item code				
Guiding rail 35	L 6070 mm					<b>EV 1</b> 113066
Running rail 37	L 6070 mm			<b>EV 1</b> 226186	<b>brown</b> 216279	<b>black</b> 230644
Screw cover profile 38	L 6080 mm			<b>grey</b> 224346	<b>white</b> 127046	<b>black</b> 175515
Cover profile, bogies 39	L 5220 mm	<b>silver</b> 232423	<b>white</b> 232429	<b>black</b> 232426	<b>brown</b> 238696	<b>blank</b> 232432
Holding rail H 14 38	L 5220 mm	<b>silver</b> 234656	<b>white</b> 234650	<b>black</b> 234662	<b>brown</b> 235786	<b>blank</b> 234644
Connecting rod D 10 40	L 3600 mm					110387
Accessories cover caps bogies, large 44 45		<b>silver</b> 228715	<b>white</b> 228721	<b>black</b> 228718	<b>brown</b> 240235	
Accessory rail set		<b>silver</b> 230611	<b>white</b> 230614	<b>black</b> 230617	<b>brown</b> 238816	<b>blank</b> 230611
Guide block, movable 49					<b>brown</b> 203754	<b>silver</b> 203748
Stay system (PU 10 units) 26				FB 650- 930		220302
				FB 931-1280		220326
				FB 1281-1680		220350
Locking rod 58	L 6000 mm					190294

# Strikers

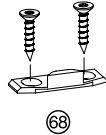
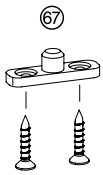
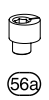
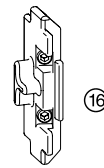
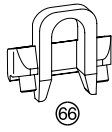
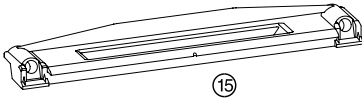

- 13 Striker V.01/V.02
- 15 Tilt lock striker
- 16 Buffer anti-mishandling device
- 56 Insertion stud D10
- 56a Rivet stud D6
- 66 Guide
- 67 Plate top, scheme C
- 68 Plate bottom, scheme C

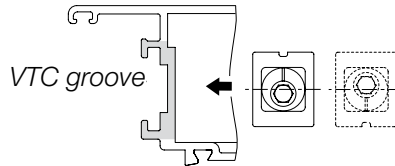
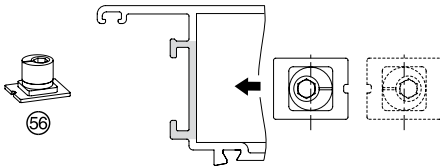

**D10**

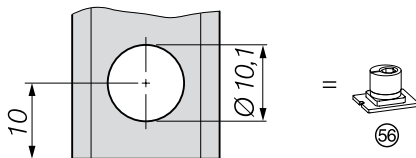
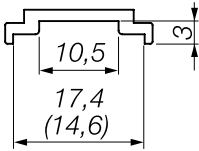

**D6**

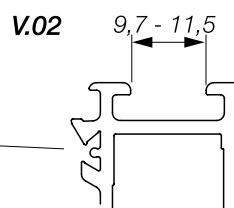
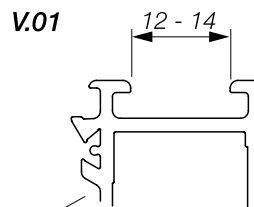
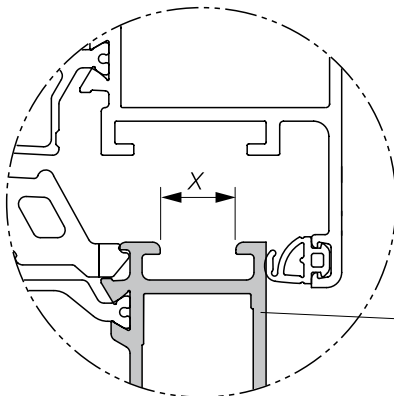
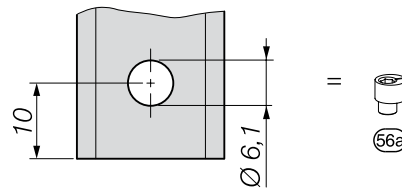
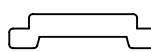



# Strikers

## Z design

Item name	Item code		
	Groove V.01	Groove	
<b>Accessories striker set HKS 200 Z</b> ⑬ ⑮ ⑯ ⑳			
<b>V.02</b> Basic set for all Z designs	232789	232792	
<b>Accessories insertion studs D 10</b> 3 units ㉔ (always required for all Z designs) <b>as an alternative</b> , depending on the locking rod used		232795	
<b>Accessories rivet studs D 6</b> 3 units ㉔a (always required for all Z designs)			232798
<b>Accessories scheme C strikers HKS 200 Z</b> ㉗ ㉘	<b>Groove 10</b> 113768	<b>Groove 12</b> 113771	<b>Groove 14</b> 113774
Scheme C strikers, top/bottom for all Z designs			

## S design

Item name	Item code	
	Groove V.01	Groove
<b>Accessories striker set, insertion studs D 10</b> ⑬ ⑮ ⑳		
Basic set for S design with insertion studs D 10 <b>as an alternative</b> , depending on the locking rod used	232819	232822
<b>Accessories striker set, rivet studs D 6</b> ⑬ ⑮ ㉔a		
Basic set for S design with rivet studs D 6	232813	232816
<b>Accessories tilt-lock striker set</b> ⑯ for different locking system design o.V.	232825	232828

## Z+S design

Item name	Item code	
	Groove V.01	Groove
<b>Accessories locking parts with insertion studs D 10, size 10 PU (10 pcs.)</b> ⑬ ㉔		
for optional closing positions as specified in the note below S+Z design <b>as an alternative</b> , depending on the locking rod used	232801	232807
<b>Accessories locking parts with rivet studs D 6, size 10 PU (10 pcs.)</b> ⑬ ㉔a		
for optional closing positions as specified in the note below S+Z design	232804	232810

**Note:** It is necessary for sash widths and sash heights of > 1680 mm and > 2180 mm, respectively, to set additional locking positions. This requires the use of the bag of accessory locking parts (depending on the design, either D 10 or D 6).

## Mounting tools

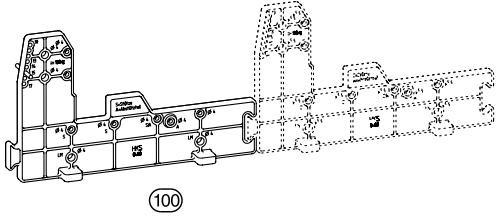

100

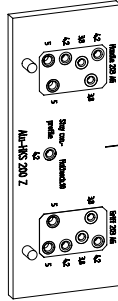

101

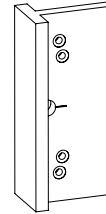

103

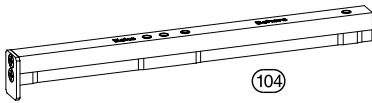

104

- 100 Jig for bogies, cover fillet supports, and support arms
- 101 Jig for gear with fork drive handle (AG) and holding rail
- 103 Jig for gear with fork drive UG and UG-S
- 104 Jig for corner and stay
- 105 Screw jig for running rail and guiding rail
- 106 Tool for glider release, stay alignment and anti-lifting device
- 107 Drill centring device
- 108 Screw jig - guide block
- 109 Jig for movable guide block

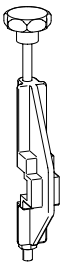

105



106

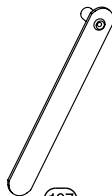

107

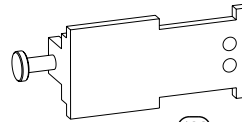

108



109



## Mounting tools

Item name	Item code
Jig for bogies, cover fillet supports, and support arms <sup>(100)</sup>	215277
Jig for corners and stays <sup>(104)</sup>	206860
Jig - handle UG <sup>(103)</sup>	173281
Jig - handle 203 AG <sup>(101)</sup> , holding rail	234782
Screw jig- guiding rail/running rail <sup>(105)</sup>	215256
Screw jig for guide block <sup>(108)</sup>	215301
Jig for movable guide block <sup>(109)</sup>	217971
Drill centring device <sup>(107)</sup>	110747
Tool - glider release <sup>(106)</sup> <i>must also be used to align the stay and as a tool for the anti-lifting device</i>	215283

## Documents - overview

Document	Language	Item code
Installation instructions Alu-HKS® 200 Z	German	232777
	English	233590
Installation instructions Alu-HKS® 160 S	German	232783
	English	233596
Installation instructions Alu-HKS® 160 S o.V.	German	233935
	English	233938
Supplementary instructions EG / scheme C Alu-HKS® 200 Z	German	233593
	English	233593
Maintenance and operating instructions Alu-HKS® 200 Z	German	232780
	English	232780
Maintenance and operating instructions Alu-HKS® 160 S und 160 o.V.	German	232786
	English	232786
Supplementary instructions Alu-HKS® 200 Z FH > 2180 FB > 1680	German	234829
	English	234829











**You know when it's HAUTAU.**



166769 • 09.1/2013

HAUTAU GmbH  
P.O.Box 11 51  
D 31689 Helpsen  
Phone +49 5724/393-0  
Fax +49 5724/393-125  
Info@HAUTAU.de

[www.HAUTAU.de](http://www.HAUTAU.de)



**HAUTAU**